

LIGHTING FIXTURE INDEX

LED Cyclorama	142 - 143
Outdoor LED par	144
LED Par Can	145 - 146
LED Audience Blinder	147 - 148
Event Spot	149 - 150
Tungsten Junior	151 - 154
Mega Lite	155
Mega Par	156
Outdoor Par	157
Par Can	158 - 159
Cyclorama & Flood Light	160 - 161
Fresnel & Prism Convex	162 - 163
Audience Blinder	164 - 167
Followspot	168
Shop Light	169
Mini Projector	170
Track & Accessories	171
Lighting Control Accessories	172 - 176
Dichroic Filter	177 - 179
Honeycomb	180
Gooseneck Lamp	181
Lighting Control System	182 - 183
DMX Tester	184
Digi Fan	185 - 186
Mirror Ball & Motor	187
Goreal Intercom	188 - 189
Haze & Fog Machine	190





Content

Kupo is a leading producer of professional lighting fixtures for theatre, events, and concerts. We have various lighting fixtures available, including the conventional par can, audience blinder, cyclorama & flood light, Fresnel & Prism Convex, Xenon followspot, to the newly-launched Tungsten junior series, Megapar & Megalite, event spot and fixture with discharge lamp source.

Come and join us on www.stage.com.tw



LED Cyclorama

Kupo LED cyclorama delivers pure and even color wash with powerful light outputs. The 150W luminaires is fabricated of aluminum alloy housing, making it lightweight yet rigid. Similar to classic Par Can, this cyclorama is made with big lock washers providing positive firm lock while rigging with the bracket. The asymmetric anodized aluminum reflector deliver wide and even light distribution. Available with three visible light models, RGBA, warm white, tunable white (warm white + cool white) and also invisible light source UV LED for special effect in theme park.

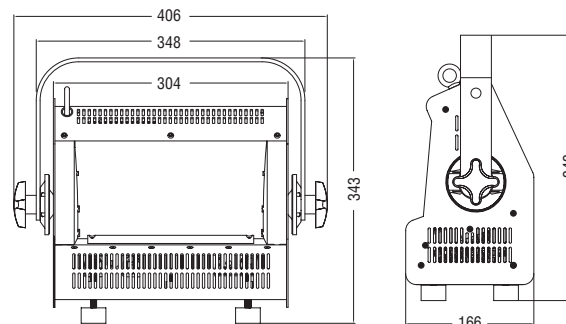

Item	Description
ZLC-150RGBA	150W RGBA LED CYCLORAMA
ZLC-150WW	150W 3200K WARM WHITE LED CYCLORAMA
ZLC-150TW	150W 3200K-6000K TUNABLE WHITE LED CYCLORAMA
ZLC-150UV	150W UV LED CYCLORAMA



Yoke lock washer provide positive locking; ventilation slot makes the better controls of working temperature.



Anodized asymmetric aluminum reflector gives the light output distribution even and smooth. Large solid bracket provides durable and robust rigging support for the luminaire. An eye ring is equipped for attaching the safety bond.



LED light engine consists of 48pcs LED, available with RGBA, 3200K warm white, tunable white (3200K warm white + 6000K cool white), and UV LED at 365nm.



On-board LCD screen clearly displays the function and all settings through push buttons. DMX controllable through 3pin or 5pin XLR outlets.

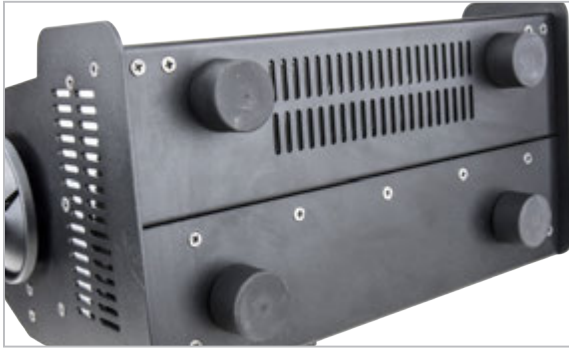

Rubber footpad for stabilizing the luminaire while it is upright on the ground.

Features

- Full DMX-512 controllable
- Universal Power Input: AC/100-240V, 50/60Hz
- Both power and signal feed through for daisy chain
- Asymmetric aluminum reflector
- Yoke lock washer and solid large bracket for positive lock; eye ring for safety bonding
- Available with RGBA, 3200K Warm White, Tunable White (3200K-6000K) and UV LED
- Rubber footpad protects the housing from scratch in upright position
- Functions (for RGBA mode): Color mixing, automatic color change, built-in program and strobe effect with adjustable speed, dimmer, master / slave

Specification

Voltage	AC/100-240V, 50/60Hz
Power Consumption	Max. 150W
Light Source	48 x 3W RGBA LEDs
	48 x 3W Warm White LEDs (3200K) 24 x 3W Warm White (3200K) + 24 x Cool White(6000K) LEDs 48 x 3W 365nm UV LEDs
Signal Connector	3pin and 5pin XLR
Working Mode	DMX-512, Max 16 channels Stand-alone built-in program Strobe effect Dimmer 0-100%, fade effect Master-Slave mode
Protection Classification	IP20
Dimension	406 x 166 x 343.7 mm
Weight	5.7kgs





Outdoor LED PAR

This 180W Outdoor PAR LED luminaire is made of die-cast aluminum alloy. Sturdy and robust. IP65 rated for short-run or permanent installation surrounding with moisture. The housing is made with grooves, offering better heat ventilation. Standing on the ground or rigging on the truss can be easily convertible with two supportive brackets. Power and DMX-512 signal lead are pre-wired with water-proof connectors, for making feed-through conveniently. Function setting panel and display screen are well protected against the water ingress for maximum service life.

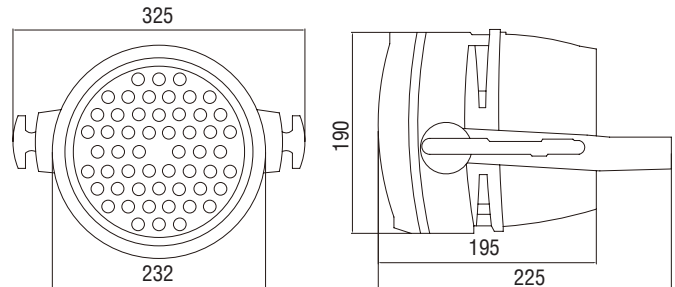

Inbuilt with 18 x high power RGBW (10W) LEDs, delivering heavy light output.

Item	Description
ZPW-64 / 18-10	180W RGBW LED OUTDOOR PAR



Grooved aluminum die-cast housing features lightweight and toughness, and great with heat ventilation. Two full-size brackets give strong rigging support.



Function setting and display screen are insulation against the moisture and dust for the maximum durability.



Power and signal leads are pre-assembled with watertight metal cable gland. Cables are over-molded with IP65 connectors to make the power and DMX-512 signal feed through without moisture issue.

Features

- Functions: Color mixing, built-in program and strobe effect, dimming, master/slave.
- 0-100% linear dimming.
- Power & signal feed through with IP65 connectors.
- Fully comply with DMX-512 protocol.
- 4-digit LED setting menu with function buttons.
- IP65 protection classified for outdoor application.



Specification

Voltage	Power Consumption	Light Source	Signal Connector	Working Mode	Protection Classification	Dimension	Weight
AC/100-240V, 50/60Hz	Max. 180W	18 x 10W RGBW LEDs	3pin water-proof XLR	DMX-512, Max 7 channels Stand-alone built-in program Strobe effect Dimmer 0-100%, fade effect Master-Slave mode	IP65	280 x 290 x 290mm	5.5kgs



Led Par Can

LED PAR CAN renders vivid and colorful changing effect in the stage. Kupo's LED PAR is build up with PAR-64 sturdy textile of barrel and equipped with high power RGB LED, making it the ideal choice and catering to the entertainment requirement. Standard finish is black while white or other color is available for special request. In addition to the version with RGB color mixing, fixed color LED PAR CAN including 3,200K warm white and 6,200K cool white are also available. An unique design on daisy chain power is set to offer simple and convenient access to the electricity; up to 10 units of LED PAR can be put together for power linkup.



for sound active effect.

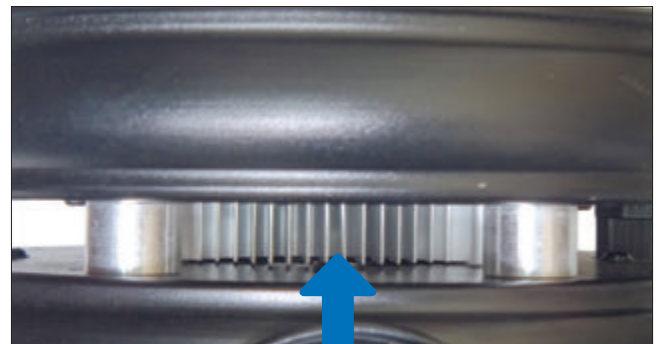

heat sink for better ventilation.



for master & slave.



fixed spring set.



Led Par Can

DRAWINGS

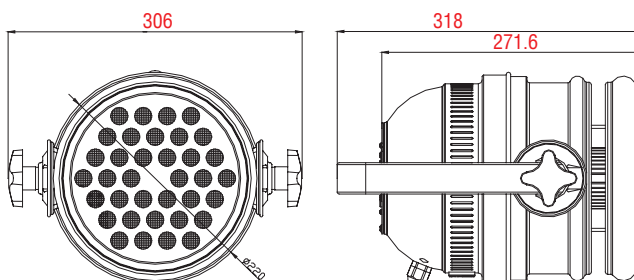

ZPL-64 / 36-3

Voltage: AC 100-240 V / 50-60 Hz

Power Consumption: 120 W

LED Unit: 36 pcs * 3 W LEDs (Red 12 pcs/ Green 12 pcs/ Blue 12 pcs)

Beam Angle: 10 / 25 / 45 / 60 degree optional

DMX Channel: 5 & 6 channels

Control: DMX 512 / Master & Slave

Effect: RGB mixed color, dimming mode, flash, color changing, color fading and sound active

Working Environment: Indoor -20~50 degree C

Net Weight: 2.95 kg

DRAWINGS

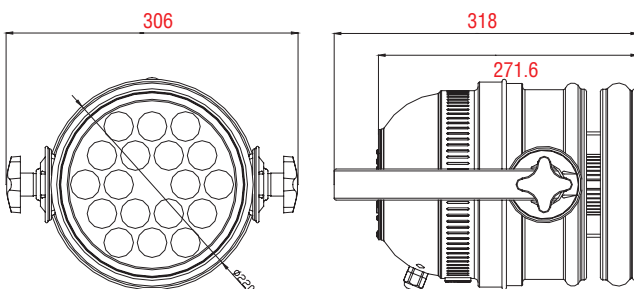

ZPL-64 / 18-10

Voltage: AC / 100-240 V, 50 / 60 Hz

Power Consumption: 180 W

LED Unit: RGBW, 18 x 10 W (4-in-one), 3200 K or 6500 K (white)

Beam Angle: 25 / 45 degree optional

DMX Channel: 1-7, 16 channels

Control: DMX 512, Master / Slave

Effect: Color mixing, dimming mode, fading, sound active

Working Environment: Indoor -20~50 degree C

Net Weight: 2.9 kg



LED Audience Blinder

With enjoying years of reputation for its high fabric quality of audience blinder, now blending with LED luminaires, Kupo extends the series to a more eye-ball catching scope. Unique and modular housing design is simple, which makes an upgrade from conventional light source to LED rather easy to conduct. Every LED module is equipped with 12 pieces of 3-in-one 3 W LEDs. This turns out that Kupo's Audience Blinders possess the highest powerful output in the market now as the catalogue printed. First grade aluminum material is used to build up the LED housing, offering excellent ventilation. Fan-free design meets the benchmark of those where silence is strictly required. Both 4-lite and 8-lite are available.

Specification



- Universal power input, AC / 90 - 240 V input, Powercon.
- Power consumption: 144 W for 4 lites, 288 W for 8 lites (per module is 36 W)
- LED Power: DC / 48 V
- Fuse: 5A / 250 V
- DMX-512 compatible (3-pin XLR)
- Beam Angle: 20 degree
- Lumen: 1058 (per module)
- Lm/W: 20.99 (per module)
- IP Rating: 20
- Ambience temperature: -10~40 degree C
- 4-digit LED panel display setting
- Size: 425 (L) x 183 (W) x 520 (H) / 4-lite 425 (L) x 183 (W) x 700 (H) / 8-lite

Product Code	Description
ZSB-364	Led Audience Blinder 4-Lite.
ZSB-368	Led Audience Blinder 8-Lite.



Robust and rigid, and easy to fit into from front panel.



Aluminum die-casting housing with fin design for best heat ventilation.



Power in and thru for flexible power connection.



External rear module for reliable power and control management.



LED Audience Blinder (Light Duty)

Light duty LED audience blinder is assembled with KUPO's reputed 4-lite and 8-lite audience blinders and the state-of-the-art LED light source, offering a vivid and astonishing color changing effect. LED module is equipped with 9 CREE LED which ensures the reliability and durability, and mounted in an aluminum-extruded chassis for maximum heat dissipation. LCM (LCD Module) display on rear panel for clear identification while setting the mode. Slim and light-weighted profile renders the great mobility.

Specification

- Universal Power Input: AC / 90-240 V, 50-60 Hz.
- Power Consumption: 240 W (8-lite), 120 W (4-lite).
- Powercon in and out.
- LED Power: DC / 24V.
- DMX-512 compatible (3-pin & 5-pin XLR).
- Beam Angle: 25 degree.
- Lumen: 754 (Per module).
- Lm / W: 30.90.
- IP Rating: 20.
- Ambience temperature: -10~ 40 degrees.
- LCM Panel display setting.
- Weight: 17.50 kgs.
- Dimension: 4-lite / 425 x 520 x 100 mm; 8-lite / 425 x 810 x 100 mm.

Product Code	Description
ZSB-364E	4-lite Light Duty LED Audience Blinder.
ZSB-368E	8-lite Light Duty LED Audience Blinder.



Function

- DMX mode: from one channel to diverse 8 channels covering R / G / B / Marco / Strobe / Fading / Dimming / W (if any).
- Built-in 8 preset programs, with 8 different adjustable speed.
- Fixed R / G / B color mode; furthermore, user can adjust the portion to create the favorite.
- Marco mode (fixed color) : preset 32 palette colors for flexible utility without DMX.
- Sound active.



LED Event Spot

Solar represents the fixture with higher color temperature, namely the light source of white LED and discharge lamp. The latest model to the series is LED Event Spot. Inherited with the profiles of classic HMI 575 Event Spot, the LED version, featuring energy-saving advantaged, is made with 32pcs superior high power LED with custom-fit lens to produce as 8000 (LUX) great intense light as astonishing and incomparable high output (measured in white LED at 7 meter ahead of fixture without diffuser). Three diffusers kit comes standard to provide softer edge choices for versatile applications. Ventilation holes are deployed around the back housing for better management of working temperature so as to prolong the life span of LED.

Excellent mechanical fabrication, such as die-cast spring gel clip, positive locking knobs and robust U bracket enhances the durability. Universal power input is global-fit no matter where the event takes place. Light weight and three colors (black, white, metallic silver) for selections.

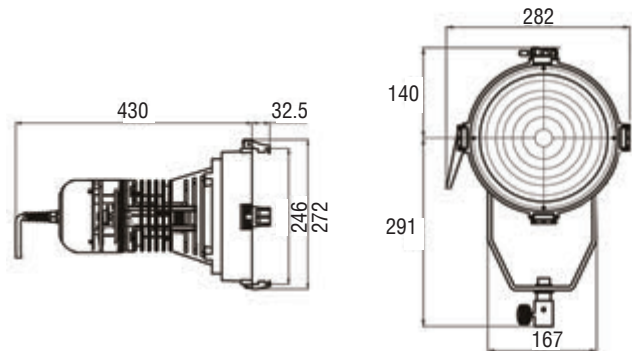

Features

Item: ES-LED300
 Light Source: 32 pcs High-Power LED
 Power Consumption: 300 W
 Input Voltage: AC90-260 V
 Output: 8000 Lux (at 7 meter w/o diffuser)
 Color Temperature: 5600 K
 Power Factor: ≥ 0.98
 LED Life Span: 50,000 hrs
 N.W.: 7 kgs

Three diffusers with frame soften light beam and produce wider FIELD. Standard comes one diffuser only.



- Diffuser with "blue" ear frame:
diffusion with 55 degree, and 450 Lux at 7 meter.
- Diffuser with "yellow" ear frame:
diffusion with 30 degree, and 1200 Lux at 7 meter.
- Diffuser with "black" ear frame:
diffusion with "linear effect", and 1300 Lux at 7 meter.



- Four-leave barndoor comes standard to control the light spill.

Event Spot [ES-HMI 575]

Kupo Event Spot HMI 575 is designed for not only photography, film / TV but specially for exhibition and event including motor show. With 575 HMI output and the 5,600 K day light, Event Spot 575 brings the extreme brightness to meet the requirement of the illumination in above locations.

1. Manual dimmed control for adjusting the brightness.
2. Hot restrike igniter keeps continuous output of the lights while the power temporally off.
3. Barndoor as the standard accessory to specific distribution of light.
4. Comes with interchangeable Frost Lens (Narrow Spot).
5. The 4th spring clipper keeps barndoor and lens holder stay firmly on the fixture.



Black



White



Silver-gray

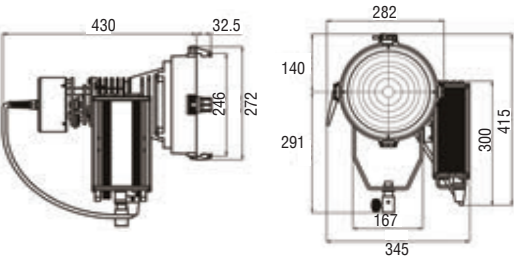

Four Pattern Lenses

Big grid, Small grid, Frosted, Frensel



Product Code	Description
Power: 575W	4-Leaf Barndoor: 245 mm
Supply Voltage: Auto sense 90V-240V	Electronic Ballast: EB 575, 115 / 230 V
Color Temperature: 5,600 K	1 pc Lens : Dia 205 mm
Measurement: 450 (H) x 300 (W) x 450 (L) mm	
Weight: 7.1 kg	Optional Accessories
Lamp Type: HMI 575 W / SE	Extension Cable: 7M / 15M
Lamp Base: G22	
UV Lens Dia.: 205 mm	
Protection Class: IP23	
Compliance: CE	

Photometric (event Spot Hmi 575w)

Lens	Projected Distance	3M	5M	10M	Beam Angel
Without lens	Brightness (Lux)	205,000	73,800	18,500	5°
	Projected Diameter (meter)	0.3	0.4	0.5	
Spot	Brightness (Lux)	82,880	29,900	7,500	9°
	Projected Diameter (meter)	0.5	0.8	1.6	
Narrow Flood	Brightness (Lux)	33,600	12,000	3,040	11° x 22°
	Projected Diameter (meter)	0.6 x 1.2	1 x 1.9	1.9 x 4	
Flood	Brightness (Lux)	9,500	3,400	850	21° x 42°
	Projected Diameter (meter)	1.2 x 2.4	1.9 x 3.9	3.7 x 7.9	
Wide Flood	Brightness (Lux)	7,200	2,600	650	42°
	Projected Diameter (meter)	2.3	3.8	7.7	



Tungsten Junior



IP23 rated & CE compliant



Kupo present a latest range of fixture, classified in "Lunar and Solar" categories for specifically highlighting color temperature, Tungsten Junior and Solar, featuring warm and white tone of color temperature respectively, are made to satisfy the need for diverse application. Lunar symbolize the fixture with tungsten source. Though enveloped under the atmosphere that LED is the future with a long-run campaign for carbon emission reduction, tungsten has beautiful characters in terms of dimming performance and color rendering that yet to be surmounted. Save Tungsten!



■ 150W Fresnel



■ 300W Fresnel



■ 650W Fresnel



■ 1000W Fresnel



■ 2000W Fresnel



Aluminum 4-leaf barndoor and stainless steel color frame comes standard.

Tungsten Junior series has wide variety models from 150 W to 2000 W, catering to lots of requirement for 3200 K warm tone. Designed for tungsten light source, Lunar is built up with sophisticated low expansion borosilicate Fresnel lens and fine anodized reflector to create perfect soft note and evenly-distributed light field. Non-reflective black finish not only makes it less visible but blended up with installation background without additional makeup. Constructed of high tensile aluminum alloy, the housing is light weight, compact, rust-free, sturdy as well as perfect with heat ventilation. Tool-free top opening (or front opening in some models) chassis facilitates lamp change quickly within seconds. Through rotating and heat-resistance focus adjustment knob, wide field or focus beam effect can be managed easily. Sturdy in-line on / off switch is equipped in all models for handy operation. Rigid barndoor and stainless steel round-shape gel frame is supplied as durable as the complete fixture.



150W Fresnel

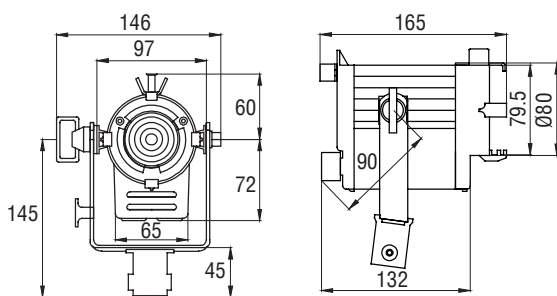

Model:	LSW-010
Watt:	150W Fresnel
Lamp / Base:	GX6.35
Dimension (mm):	165(L), 146(W),205(H)
Net Weight(kgs):	1.2
Lens Diameter (mm):	50
Barndoor (mm):	78
Filter Frame (mm):	75P
Supplied Connection:	16 mm receiver



Supplied with cable strap and inline on / off switch.
(3M cable, 3C x 1.5 mmsq)



300W Fresnel

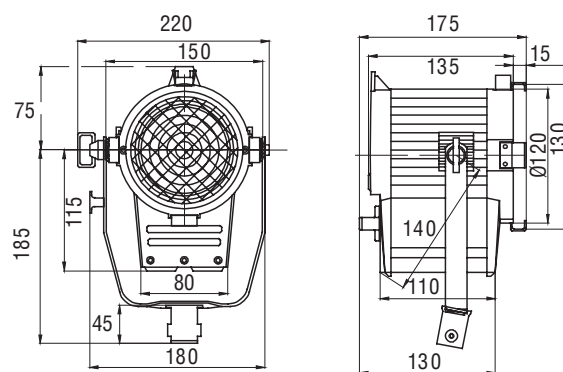

Model:	LSW-001
Watt:	300W Fresnel
Lamp / Base:	CP81 / GY9.5
Dimension (mm):	175(L), 220(W),260(H)
Net Weight(kgs):	2.1
Lens Diameter (mm):	80
Barndoor (mm):	128
Filter Frame (mm):	130
Supplied Connection:	16 mm receiver



Supplied with cable strap and inline on / off switch.
(3M cable, 3C x 1.5 mmsq)





650W Fresnel

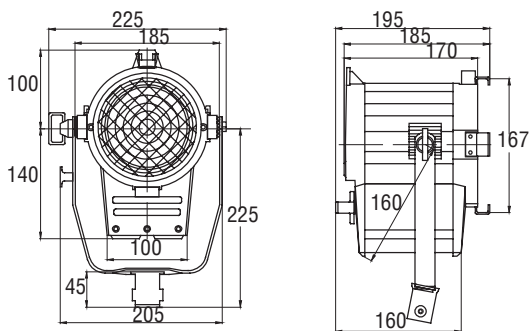

Model:	LSW-002
Watt:	650W Fresnel
Lamp / Base:	CP89 / GY9.5
Dimension (mm):	195(L), 225(W),325(H)
Net Weight(kgs):	2.5
Lens Diameter (mm):	112
Barndoor (mm):	162
Filter Frame (mm):	170
Supplied Connection:	16 mm receiver



Supplied with cable strap and inline on / off switch.
(3M cable, 3C x 1.5 mmsq)



1000W Fresnel

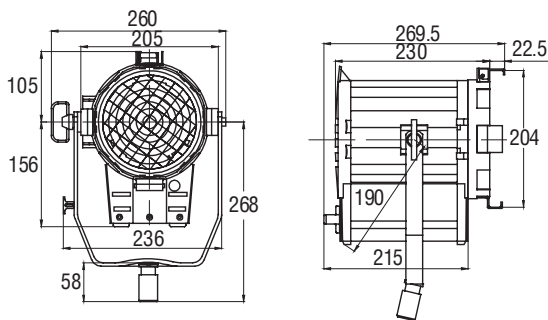

Model:	LSW-003
Watt:	1000W Fresnel
Lamp / Base:	CP40 / G22
Dimension (mm):	270(L),260(W),373(H)
Net Weight(kgs):	5.3
Lens Diameter (mm):	130
Barndoor (mm):	194
Filter Frame (mm):	192
Supplied Connection:	16 mm receiver



Supplied with cable strap and inline on / off switch.
(3M cable, 3C x 1.5 mmsq)





2000W Fresnel

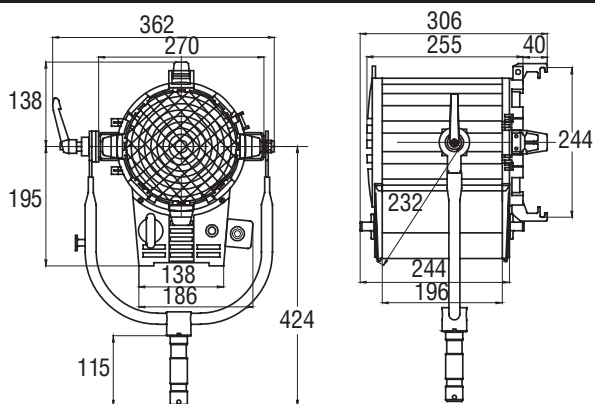

Model:	LSW-004
Watt:	2000W Fresnel
Lamp / Base:	CP73 / G38
Dimension (mm):	306(L),362(W),562(H)
Net Weight(kgs):	9
Lens Diameter (mm):	175
Barndoor (mm):	245
Filter Frame (mm):	230
Supplied Connection:	28 mm spigot



Supplied with cable strap and inline on / off switch.
(3M / 3C x 2.5 mmsq power cable)



Features



Cable strap is supplied to all models providing excellent cable management; in-line on/off switch is equipped for conveniently near field control.



Rear and front focal adjustment knobs are made from heat-resistant thermoplastic for comfort operation. This fixture comes with 3M / 3C x 2.5 mmsq power cable.



Spiral cable gland stops power cord from over bending; cable comes less stressful as it is in line with the direction of fixture while tilting down.



Ratcheted handle, coming with large disk brake, for positive and effortless locking.



Color frame clip and front chassis are both spring-loaded; press to open and make the maintenance easy and tool free.





Megalite is known for its outstanding characters and excellent craftsmanship. It is made in black with non-reflective matt painting for less visibility where any glittering is strictly controlled. Ideal for not only the theatre but also for the venues where precise light control is required.

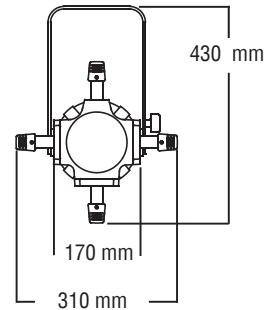
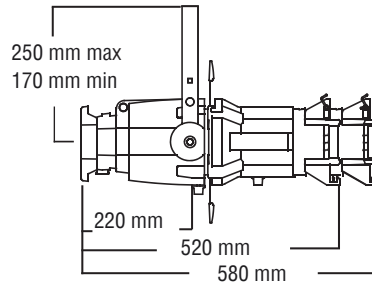

Item	Description
ML-7519B	Megalite with 19 degree lens tube, Black
ML-7526B	Megalite with 26 degree lens tube, Black
ML-7536B	Megalite with 36 degree lens tube, Black
ML-7550B	Megalite with 50 degree lens tube, Black



Rugged shutters, made of resilient stainless steel, ensure deformation proof with either 575 or 750W lamp in operation; slot for seating Iris, pattern holder and other great accessories.



Locking knob, fabricated with heat-resistant thermoplastic, together with large disc for firmly positioning.



Aspherical lens on the front tube authentically produces great image contrast and eliminates the distortion; spring clip facilitates accessories attachment easily.



Focal adjustment or interchangeable lens tube is just as simple with a knob beneath the lens tube.

Features

- Die-cast aluminum alloy housing, featuring sturdy and robust and handling great ventilation for such compact fixture with high light output, leaves it the best choice for installation and rigorous touring environment.
- Plastic parts on the fixtures are made of heat-resistant thermoplastic for best insulation, providing the durability and safe operation.
- Sophisticated dichroic-coated glass reflector transmits the IR heat to the back side, and produces cooler visible light forward.
- Front aspherical lens efficiently eliminates the distortion on the rim of output image and ensures fidelity.
- Resilient stainless-steel shutter operates handy beam-shaping and free from deformation with working heat.
- Tool-free lamp housing attachment facilitates the quick lamp changing .
- The series is available in 19, 26, 36 and 50 degree with interchangeable lens tube design.
- Gobos, Iris, Top hat and other light control accessories are dimensionally compatible with the major brand.
- All fixtures are equipped with 100 cm 3C x 1.5 mmsq silicon rubber cable.



MP-575B [Black]

Silver-gray or white is available upon request.

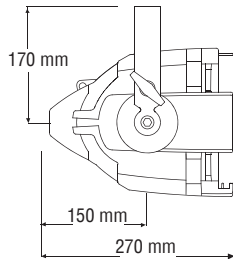
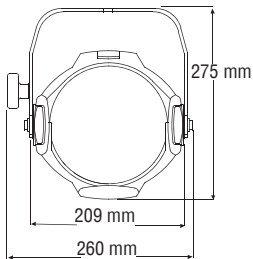

Megamix is the spinoff of MegaPAR. Equipped with two pattern rotary lens, it varies the light from spot to flood simply through a knob without changing the lens.



A quick adjusting knob at the front bottom facilitates rotating the pattern lens easily, producing evenly-casting soft field.

Features



Enhanced aluminum reflector is made of die-casting with aluminum sputtering for greatest light projection; fin construction provides superior heat convection.



Feasible for 575W or 750W lamps; contact of lamp socket is gold-plated for upmost conductivity.



Lamp housing attached to chassis firmly through a knurled and slotted brass knob, easy to handle with bare hand or with slotted driver.



MP-150EB [Megapar CDM 150W]

Made of classic model, Megapar CDM has extended-profile of yoke that offers more space to seat a side-mounted ballast chassis, which is also made of the same craftsmanship as main housing, ensuring the best heat ventilation to cool down working temperature generated by ballast. Ballast compartment space is designed for PHILIPS HID-PrimaVision electronic ballast, and also feasible to the other brands.

Part Number	Description	Color
MP-150EB	Megapar CDM 150W	Black

The Kupo CDM Outdoor Par is designed for portable or permanent installation in wet location with IP65 rating for use with CDM 150W lamps. The housing is constructed of die-casting aluminum for maximum durability and lightweight. Notches on housing give better heat ventilation. The die-casting CDM box is designed for fitting major brands of HID ballast; lamp and ballast change is easy by screw driver. The front transparent safety lens is made of 5.8 mm thickness tempered glass for maximum strength. There will be an inside lens giving light different effect, available in wide, medium and focus beam angle. Standard WP-CDM150 comes with die-casting CDM Box, IP65, with Philips HID-Prima Vision Electronic Ballast with 100 cm 3 / 1.5 mmsq VDE cable. CDM box inside dimension is 150 (L) x 94 (W) x 35 (H) mm.

WP-CDM150

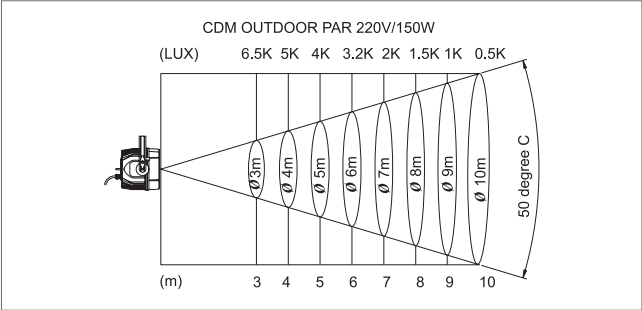
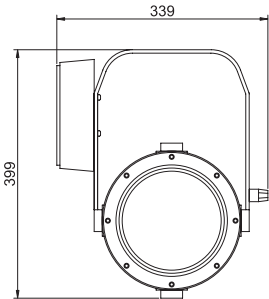

- 1. Notches on housing make ventilation better.
- 2. Die-Casting CDM Box is feasible for major brands of HID ballast.
- 3. Changeable lens gives flood, wide and narrow beam angle.
- 4. Silicon rubber ring is inserted to provide excellent water proof.
- 5. Detachable rear housing for lamp changing friendly.

Photometric Data with Different Lens

Wide Lens

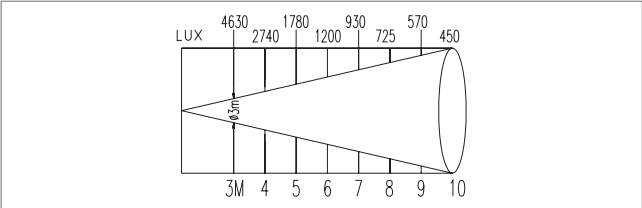

Medium Lens

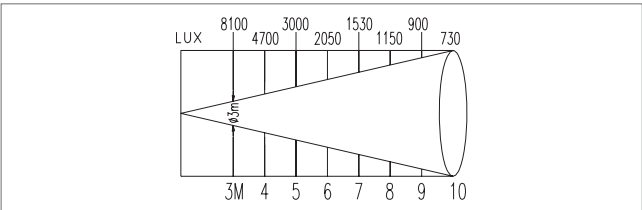

Focus Lens

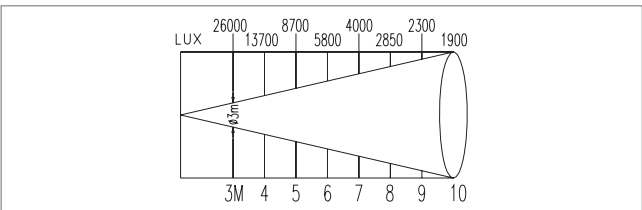

The classic and functional form of ParCans have been established in the Rock'n Roll world. Kupo ParCan is manufactured from high quality spun aluminum for maximum durability. Black and silver are standard colors, and other colors are available when specify on the order.

Features of Kupo PAR 64 / 56

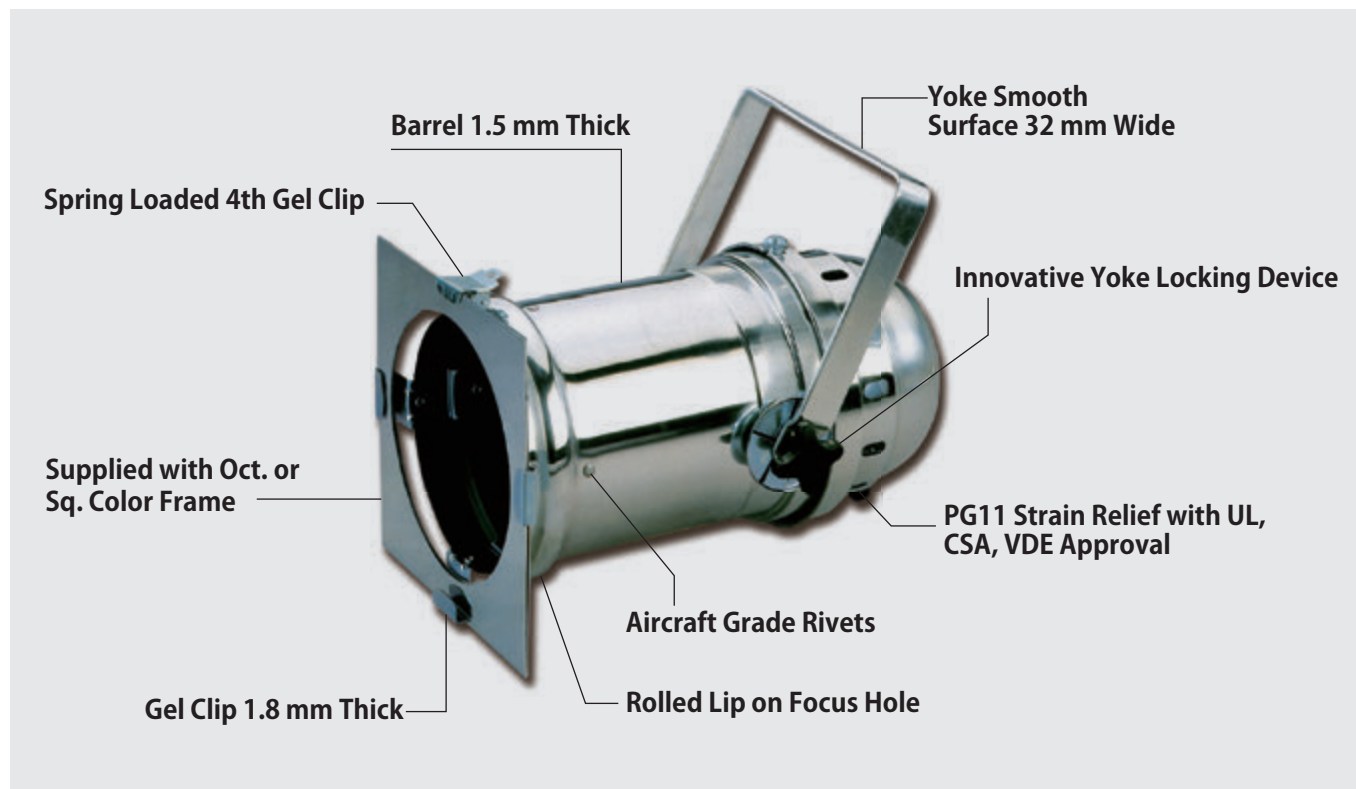

Par 64 is manufactured by using GX-16D base lamp holder for mains voltage lamps up to 1,000 watts. It is fitted with a color frame as standard. Each unit comes with a 72 cm silicon cable. Available with long nose or short nose, black or polish, floor type or customized configuration. UL version is also available.

Par 64 Long Nose

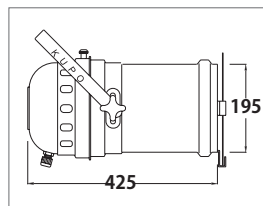

Par 64 Short Nose

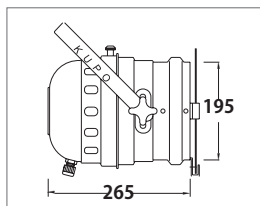

Par 64 Short Nose

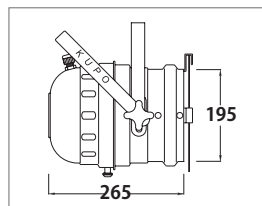

Par 56 Long Nose

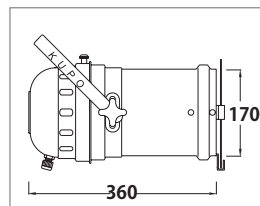

Par 56 Short Nose

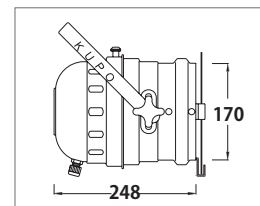

PARCAN 46 / 36

The standard Par 46 / 36 comes without lampholder base and cable unless you specify when place the order. Longnose with E27 base is with 50 cm silicon cable. It is fitted with a color frame as standard.

PARCAN 38

Par 38 lanterns are manufactured by using the E27 base wired with SJ 18AWG/3C one meter cable with Edison plug for mains voltage lamps up to 150 watts. It meets UL and cUL requirement.

Par 46 Long Nose

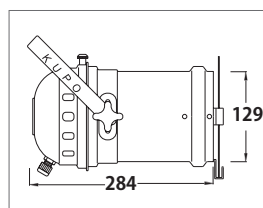

Par 46 Short Nose

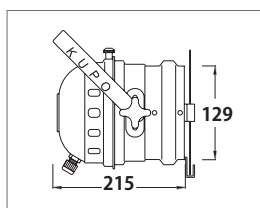

Par 36 Long Nose

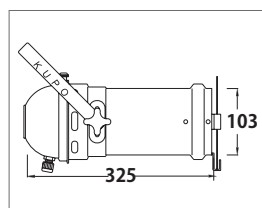

Par 36 Short Nose

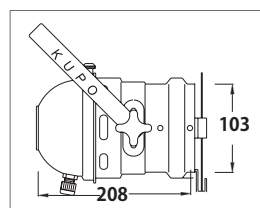

Par 38 Short Nose

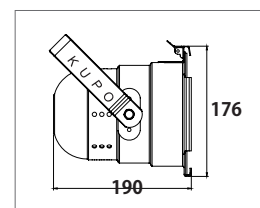

PARCAN 30 / 20

Par 30 and 20 are manufactured by using E27 or medium base lampholder for mains voltage lamps up to 150 watts.

PARCAN 16

Par 16 lantern is suitable for use with MR16 range of 12 volt lamps and GZ10 range of 230V lamps.

PARCAN 11

Par 11 is a short nose lantern using E11 socket with color frame but lamp and transformer are not supplied.

Par 30 Long Nose

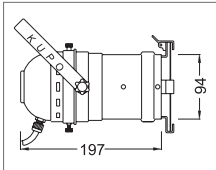

Par 20 Long Nose

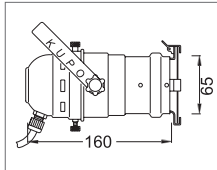

Par 20 Short Nose

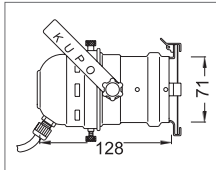

Par 16 Long Nose

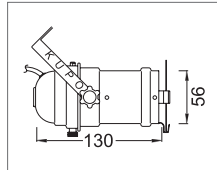

Par 16 Short Nose

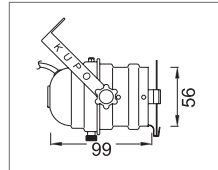

Par 11 Short Nose

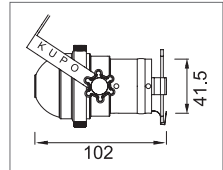

4-Leaf Barndoor for ParCan



Lightweight,compact size, foldable blade & adjustable direction four-leaf barndoor available for whole ParCan series. Standard is black finish. Other finishes are available. * Prior to purchasing barndoor, please notice the discrepancy as ParCan dimension might vary by different supplies.

ITEM Ø (mm)	A	B	C
BDR64	218	239	262
BDR56	188	210	228
BDR46	152	174	186
BDR36	121	142	169

ITEM Ø (mm)	A	B	C
BDR30	100	127	143
BDR20	56	79	88
BDR16	51	73	83

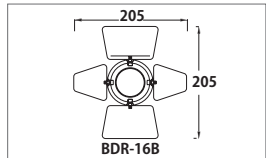
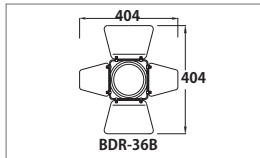
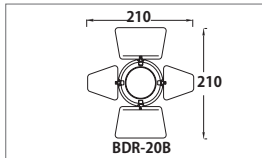
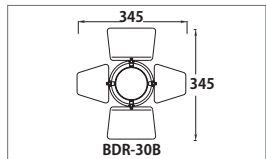
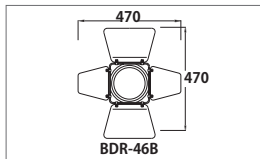
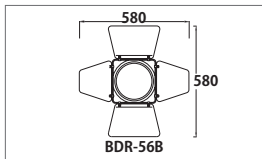
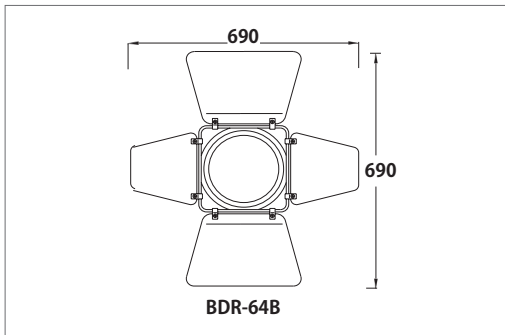

Adjuster for PAR64 & PAR56



Front



Rear

PS-64 Parsafe for Par 64 / 56



It is with high temperature resistance, which offers great benefits to can.

1. Provide safe operation when lamp is installed
2. Double electric insulation (excluding socket)



ES-01



ES-01SC



ES-02

Socket for Par 64 / 56

1. ES-01 EMEP socket.
2. ES-01SC EMEP socket with 72cm silicon cable.
3. ES-02 Top off ceramic socket



Kupo CYC & FDL are made with high standards.
The following demonstrates the features of the range.

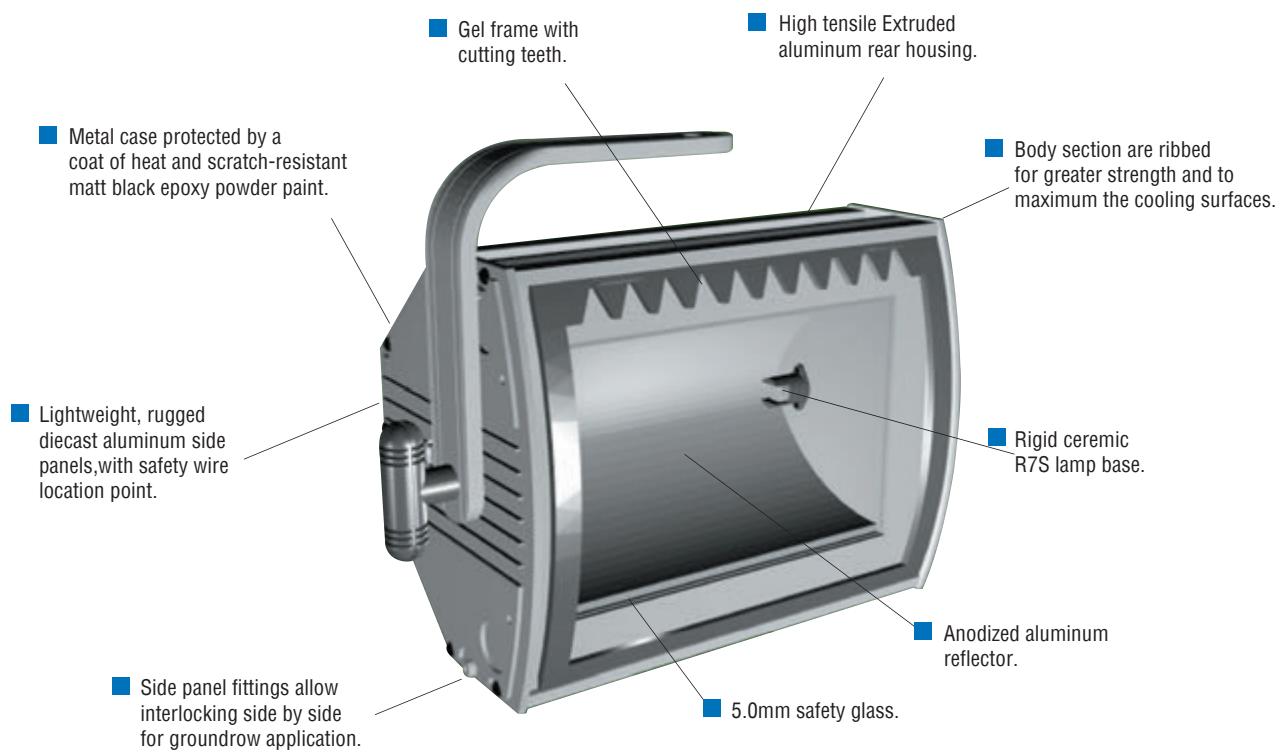

Interlocking



Fixture quickly and securely interlock side by side for ground row application.



ground row joint

TUV Version



TUV Version composes the microswitch. When door is opened power of lamp housing is automatically shut off.

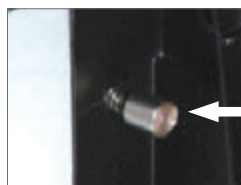

microswitch

Installation



Easy and safe lamp installation is provided via a hinged access door. Friendly and easy gel installation is supported with the hinged access door designed on color frame. The gel can be settled smoothly without wrinkle.

Ventilation



Excellent ventilation is provided with air circulation paths at both rear and front of the reflector/ lamp housing.



CYC-500 / 1000



CYC-500

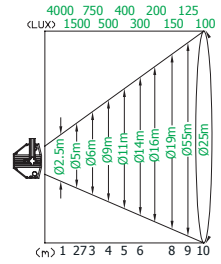
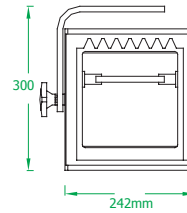
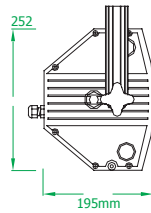

CYC-1000

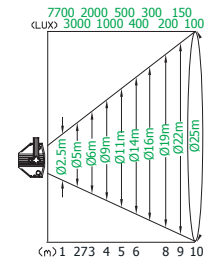
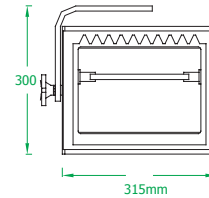
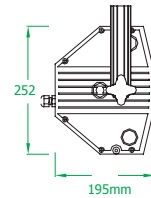

FDL- 500 / 1000



FDL-500

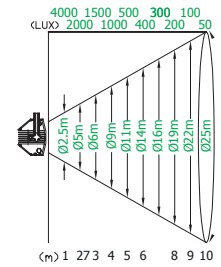
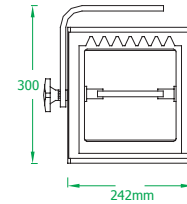
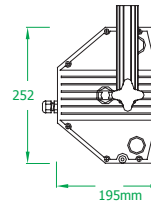

FDL-1000

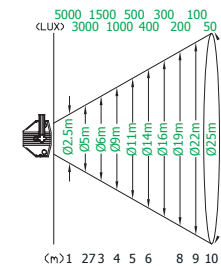
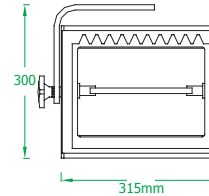
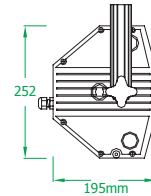

Optional Accessories / Barndoor (BDR)



BDR-500

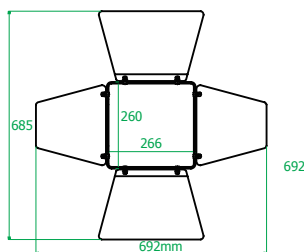

BDR-1000

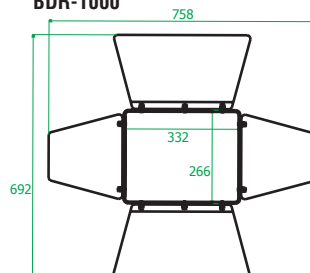

YL-1500 [Flexible linking Yoke for CYC / FDL]

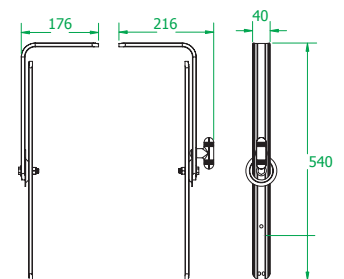

R7S Socket for CYC & FDL
Dia. 1.5 mmsq; length 25 cm.



Fresnel & Prism Convex

These two luminaires are most often used in the theatre for top or back lighting at medium throw distance. Kupo Fresnel and Prism Convex are well-known for its classic design and built with aluminum alloy, making the lighting lightweight and sturdy for theatre.

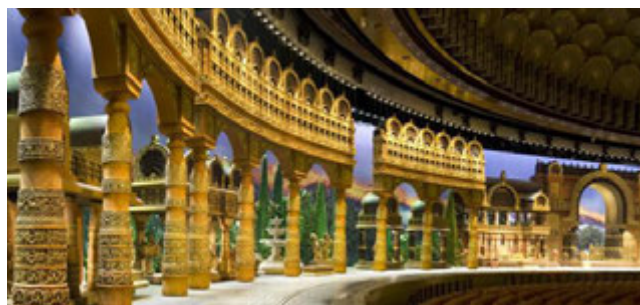

Features



Ribbed body and meshed top plate for better cooling convection.



spring design

Spring at side of front panel for efficiently setting gel frame; a lightweight folded steel gel frame is supplied.



Positive and friction disk ensures firm yoke locking; bakelite knob for greater heat resistance.



Hinge design

Hinged lamp tray for easily lamp replacement and reflector cleanup without additional tool.



Front and rear screw-pole focusing knobs for precise focal adjustment with comfort and safety.



Safety wire location hole on the rear plate for easily access



Concentric ripple Fresnel lens casts soft and even light beam projection

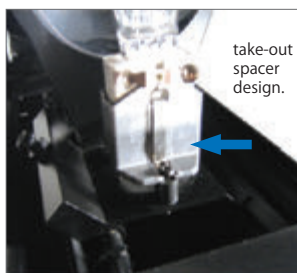

take-out spacer design.

Taking out lamp spacer turns 1000W to 1200W, and 500W to 650W fixture



Constructed of high tensile aluminum extrusion and high pressure die-cast, for max. durability and lightweight



FS-500 Fresnel Spotlight 500 / 650W

Fresnel spotlight 500 / 650W; lampholder GY9.5, Lamp: T18/500W; T26/650W, Black (take-out lampbase spacer for 650W).

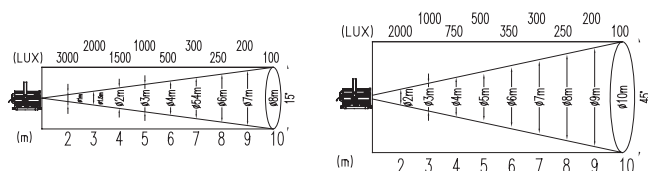
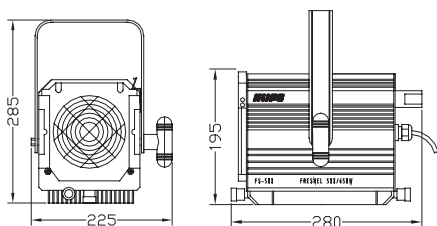

Photometric Data: Calculate for spot & flood focus from peak candela reading.



FS-1000 Fresnel Spotlight 1000 /1200W

Fresnel spotlight 1000 / 1200W; lampholder GX9.5, Lamp: T19/1000W; T29/1200W, Black (take-out lampbase spacer for 1200W).

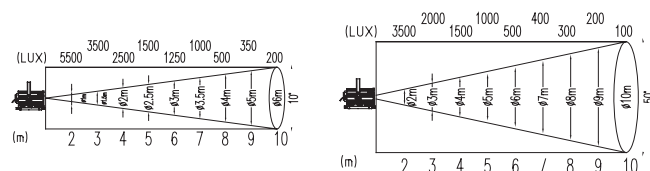
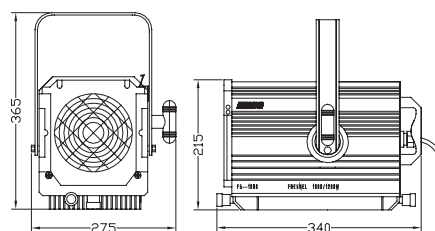

Photometric Data: Calculate for spot & flood focus from peak candela reading.



PS-1000 Prism Convex Spotlight 1000 /1200W

Prism convex spotlight 1000 / 1200W; lampholder GX9.5, Lamp: T19/1000W; T29/1200W, Black (take-out lampbase spacer for 1200W).

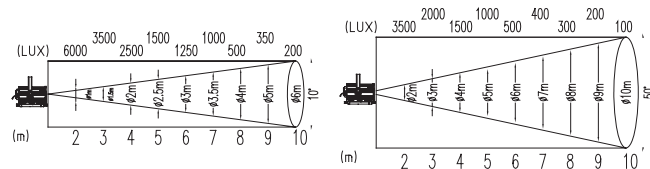
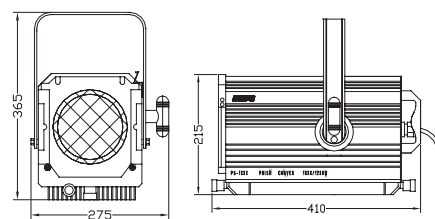

Photometric Data: Calculate for spot & flood focus from peak candela reading.

Barndoor

BDR-FS05

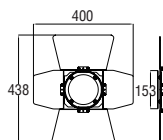

BDR-FS10

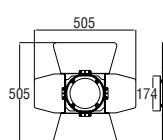

Socket

GY-9.5



GX-9.5





Audience Blinder

The audience blinders have been designed for PAR36 ACL 28V 250W or DWE 120V 650W lamps. The units consist of a sturdy, black anodized aluminum case with a strong, adjustable bracket. The rear plate with louver for better ventilation and keeping lamp life longer. The heavy duty yoke with positive lock off and T bar enables this unit to be set at any angle. Each bank can be adjusted. Both PAR64 and MR16 are delivered prewired without light sources. Please specify on order when wiring service is required.



1. Lightweight

Kupo's whole range of blinders are constructed by thick gauge of aluminum alloy metal sheet which makes the fixtures rigid and lightweight. This is the reason why it passed the devastated touring on road.

2. Better ventilation

It is designed with louver type ventilation holes on the rear plate which brings better ventilation on the fixture and keeps the lamp life longer. And, it will not cause light leakage.



3. Sturdy yoke with Positive lock

The mounting yoke with one side positive lock is for quick and reliable locking, even with additional front load such as scroller.

4. Lamp retaining ring in allowable dimension

ID113.5 mm lamp retaining rig for O.D. 111 mm PAR36 lamp. a correct allowance not too tight and not too loose.

6. Assorted range available



5. Easier lamp replacement

Rear plate is screwed, easily and friendly for lamp replacement and wiring.

7. Suitable for all major brands of color changers

The mounting holes on both sides are industry standard pitch and may fit with major brands of color changers.



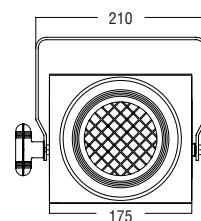
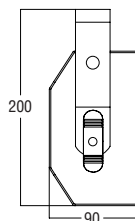

SB-361 [1LITE BLINDER]

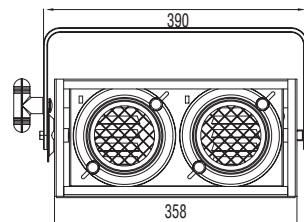
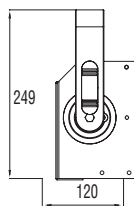

SB-362-I [2 Lite Blinder Unwired]

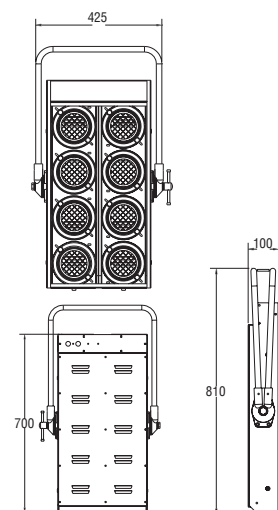
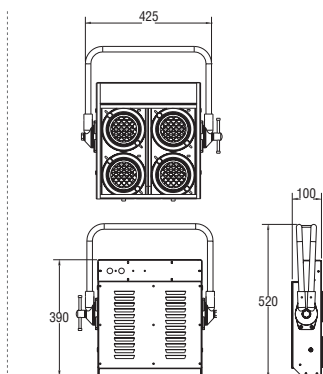

SB-364 [4LITE Blinder Unwired]

SB-368 [8LITE Blinder Unwired]



**SB-368V [8-Lite Vertical Unwired
w/ Extra Horizontal Mounting Plate]**



SB-368HY Optional Horizontal Yoke (only) With the optional horizontal yoke, SB-368V can be set in both vertical and horizontal direction.

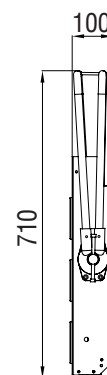
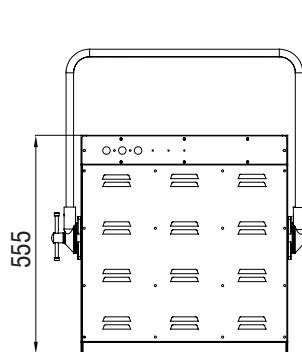
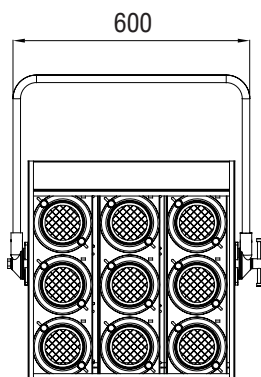

SB-369 [9-Lite Bank Lite, Unwired]

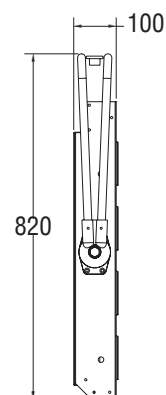
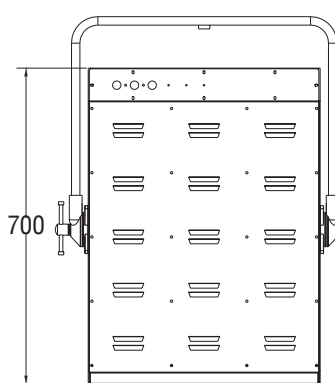
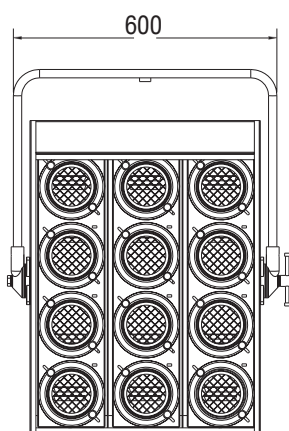

SB-3612 [12-Lite, Unwired]

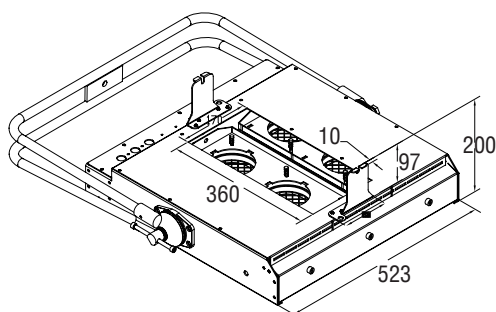

An unique combination of two effects, blinder and strobe, in one fixture. This special and fascinating luminaire is designed to merge with 3000W DMX strobe, by removing the central row of convention 9-lite blinder and affixing an unique bracket for 3000W DMX strobe easily joint together. Adding up with a color scroller, this luminaire turns to deliver impressive and powerful effect and leaves the event unforgettable. The design is working perfectly with Martin Atomic 3000W DMX strobe and major brands of 9-lite color scroller.

SB-369D [Duo Blinder]

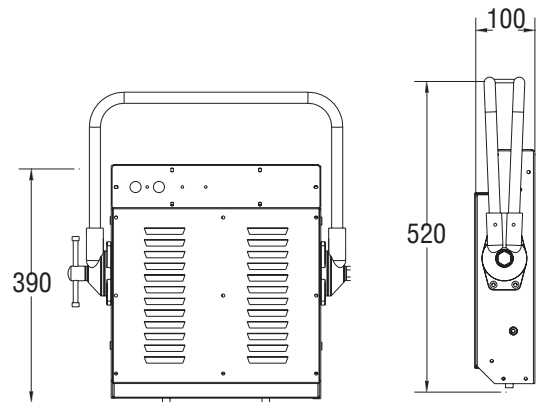
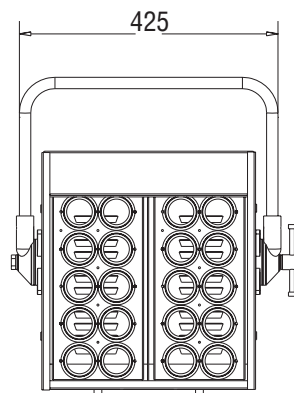

SB-M20 [MR16 20-Lite Wired]

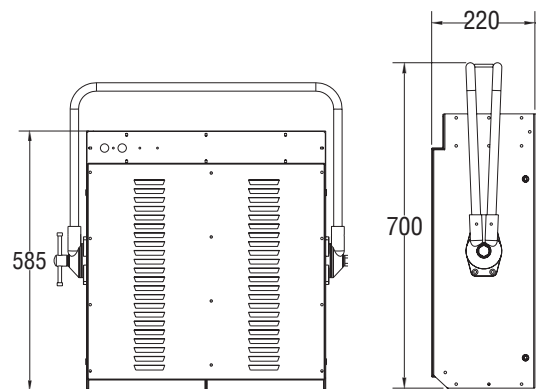
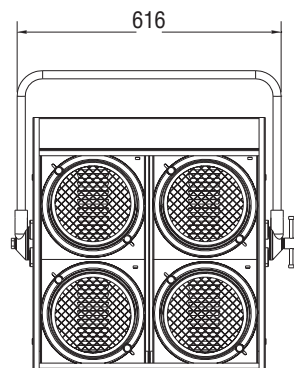

SB-644 PAR64 4LITE, Wired

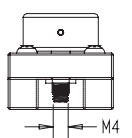
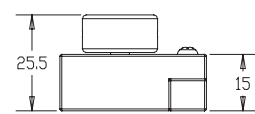
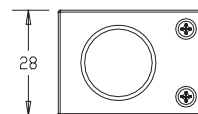

TS-36 for terminal type lamp (PAR-36, PAR-46, PAR-64)

Optional Accessory for easy wiring

TS-36 Tofu (Terminal Safe) Tofu (Terminal Safe) is made to provide user with protection from electric shock, especially for the lamp with screw terminal such as PAR36, PAR46 and PAR64 (GE4552). Ceramic finish features heat resistance and electrical isolation. Tool-free design leaves lamp maintenance easily. TS-36 is supplied without wire.

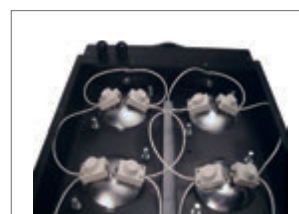



Followspot

Ideal for many stages and venues, Xenon Followspot features quick trigger and play. The cold mirror reflector makes heat pass behind and gives high visible light forward. Three cooling fans help provide better ventilation. Four rear knobs are designed for easier adjustment of lamp position. The entire set of Kupo followspot includes a ballast, stand, lamp and fixture itself. Full range of 1,000, 2,000, 3,000 and 4,000W Xenon Followspots. High quality engineering, blending ruggedness with a compact lightweight design, gives precise fingertip control of one of the world's most manoeuvrable and powerful Xenon Followspots.

KXS-1000W



- 1KW followspot
- weight: 34kg
- color changer: 3kg
- stand: 33kg
- ballast: 25kg
- lamp: Xenon 1000W

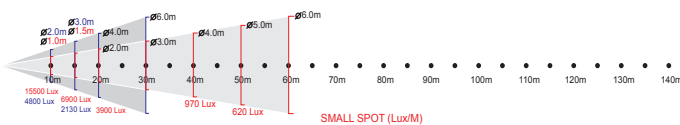

XS-2000W



- 2KW followspot
- weight: 50Kg
- color changer: 4kg
- stand: 33kg
- ballast: 25kg
- lamp: Xenon 2000W

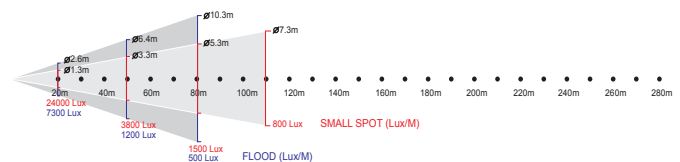

XS-3000W



- 3KW followspot
- weight: 70kg
- color changer: 4.5kg
- stand: 35kg
- ballast: 25kg
- lamp: Xenon 3000W

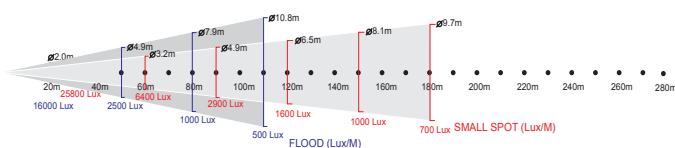



XS-4000W

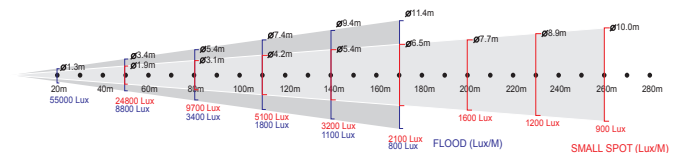

- 4KW followspot
- weight: 85Kg
- color changer: 5kg
- stand: 35kg
- ballast: 30.5kg
- lamp: Xenon 4000W



Features

1. The edge of the Iris of Kupo Xenon Followspot is smooth.
2. The operation is easy and with good safety.
3. A micro-switch (safety ring) of the lamp housing for safety. If the lamp housing is opened the power would be automatically shut off.
4. Cold mirror coating for heat transmission to support high infrared transmission and high visible light reflection.
5. Xenon Lamp  is stable at color temperature 6,000K (5,600K), high range of projection (for application in stadium, event and concert) and long life (1,000hrs), especially no need stand-by (warm up) time.
6. The ignitor is small which brings the output more focus and long distance. 

**RS-38**

PAR38 Lamp, with color frame, barndoor, E27 socket and 50cm silicon cable. Available with Black, White, Silver-gray.

**RS-30**

PAR30 Lamp, with color frame, barndoor, E27 socket and 50 cm silicon cable. Available with Black, White, Silver-gray.

**KP-HQI-382**

70W / 150W, 220V 300 (L) x 135 (Dia) mm. Available with Black, White, Silver-gray.

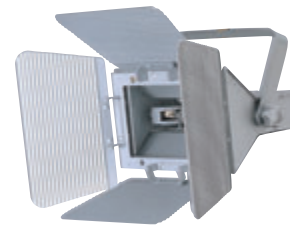
**KP-313**

300W J-Type Lamp 170(L) x 100(W) mm. Available with Black, White, Silver-gray.

**KP-PAR30-EU**

CDM PAR30 Lamp 253 (L) x 155 (W) mm for Euro Track. Available with Black, White, Silver-gray.

**SP-16LB / LP & SP-16SB / SP**

PAR16 short nose, or long nose with TT-12 track, 12V50W transformer. Available with Black, Silver. short / long.

**KP-366**

HQI-TS 70W / 150W 120V, optional 4-leaf barndoor 265(L) x 145 (dia) mm. Available with Black, White, Silver-gray.

**PJ-500**

Elegant, Aluminum Housing, Built-in 12V 50W transformer MR16 Lamp. Available with Black, White.



MINI PROJECTOR

Two adjustable lens varies zoom and focus - friendly to adjust & lock. Available in white and black finish. Recommended lamp type MR16 / 38 degree 50W or 75W. Supplied with universal adjustable mounting adaptor for attachment to track or ceiling type 12V 50W transformer.



UT-310 [Black or White]

Gobo Projector with two standard gobos Black, Weight: 1.36 kg.

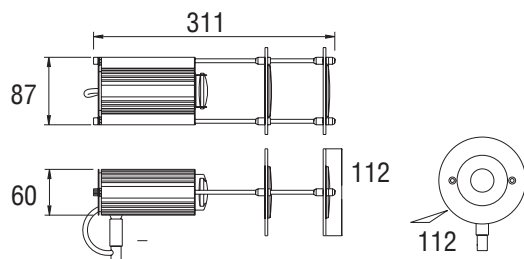

UT-330 [Black or White]

Slide Projector Black, Weight: 1.36 kg.

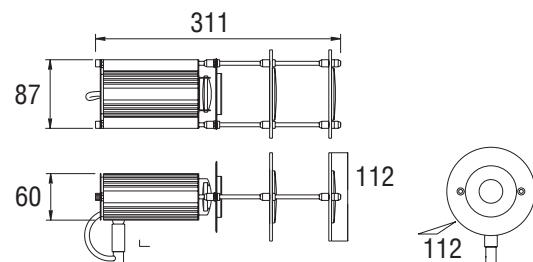

Mini Track [Black & White]



Mini Track	Description
J-110	1M Track
J-115	1.5M Track
J-120	2M Track
J-130	3M Track

Mini Track Lighting Accessories



J-131 Live End
J-132 End Cap



J-135 90 Degree Connector



J-143 Mono-point Connector



J-133 Mean Connector



J-139 Flexible Couple



J-SK Ceiling Suspension Kit



J-134A Straight Connector
J-134B Mechanical Connector



J-140 Adaptor
J-140B Track Adaptor



J-MK Wall and Ceiling Kit



Track & Accessories

Two Wires System

Black & White Color / Superior Quality



Two Wire System	Description
W-210	1M Track
W-215	1.5M Track
W-220	2M Track
W-230	3M Track

Accessories

W-231 Live End
W-232 End Cap



W-236 T Connector



W-240 Pendant Adaptor



W-234 Straight Connector



W-237 + Connector



W-241 Floating Canopy



W-235 L Connector



W-239 Flexible Connector



W-242 Outlet Box Cover
W-243 Monopoint



Four Wires System



Three Wires System

Three Phaser	Description
W-410	1M Track
W-415	1.5M Track
W-420	2M Track
W-430	3M Track

Accessories

W-431 Live End Connector



W-434 Straight Connector



W-437 + Connector



W-432 End Cap



W-435 L Connector



J-SK Ceiling Suspension Kit



W-433 Mini Joiner



W-436 T Connector



W-439 Flexible Connector
W-440 Pendant Adaptor



Transformer & Adaptor



CT-12B Black Color
CT-12W White Color
Ceiling Type 12V50W Transformer



TT-12B Black Color
TT-12W White Color
2 Wire 12V50W Transformer



W-240B Black Color
W-240W White Color
Adaptor 2 Wire



TT-SD Euro Track
12V50W Transformer



Lighting Accessories IRIS

Offering a great method for precise and smooth lighting control.



- Features are shown as below:
- aperture size adjustable from 4.5 mm to 75 mm.
 - has anti-heat absorbing radiance characteristic.
 - 3 fixed focusing hole for quick and easy positioning.
 - formulated gray painting provides as superior heat resistant as up to 450 °C for stainless steel leaves.
 - tailor-made backing plate available upon request.



ETI-F18

18 Leaves For S4, Shakespeare, S6 Series

A: 120 mm C: 13 mm
B: 137 mm D: 102 mm



ETI-F24

24 Leaves For S4, Shakespeare, S3 Series, Marumo Rayer

A: 120 mm C: 13 mm
B: 137 mm D: 102 mm



ETI-P18

18 Leaves For Pacific, Freedom

A: 118 mm C: 13.5 mm
B: 153 mm D: 102 mm



ETI-FJ18

18 Leaves For S4 junior

A: 80 mm C: 12.5 mm
B: 110 mm D: 78 mm



ETI-S24

24 leaves for SL

A: 107 mm C: 14 mm
B: 115 mm D: 102 mm



ETI-W24

24 Leaves Iris Shutter (Open To Fully Close)

A: 120 mm C: 13 mm
B: 137 mm D: 102 mm



ETI-A20

20 Leaves Iris for Acclaim

A: 95.6 mm C: 14.6 mm
B: 140 mm D: 89 mm



ETI-M12

IRIS for Moving Head

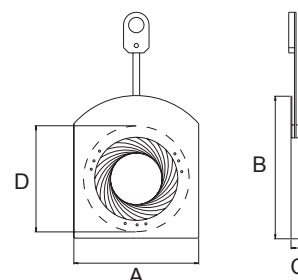



2.5" : 18 leaves Iris
for dia 46 mm aperture.



3" : 18 leaves Iris
for dia 52.6 mm aperture.



4" : 18 leaves Iris
for dia 75 mm aperture.



5" : 18 leaves Iris
for dia 90 mm aperture.

Top Hats

Size: mm

ETP-T6/T3

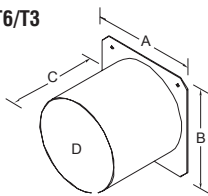

EAP-T3

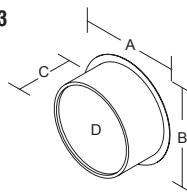

Top Hat is shaped in cylinder with a hole for light to pass through, but taking away the glint of lighting fixture directing to the audience. It is a light control device to shelter the audience eyes from the direct light source. The inner surface of cylinder is treated with black flocking so as the glare can be reduced, and the snoot is physically to eliminate the light spill.

Product Code	Distance	A	B	C	D
ETF-T5	S4, SL, SHAKESPEARE, SELECON Pacific/SPX	159	159	126	126
ETP-T6	6"LEKO	191	191	152	152
ETF-T3	SHORT S4, SL, SHAKESPEARE, SELECON Pacific/SPX	159	159	76	126
ETP-T6S	S4 ZOOM, S4 PAR, PARNEL, 6" LEKO, 360Q	191	191	152	171
ETP-T3S	S4 ZOOM, S4 PAR, PARNEL, 6" LEKO, 360Q	191	191	76	171
ETF-T10	S4 10 DEGREE, SL, 10 DEGREE	305	305	252	252
ETF-T12	S4 5 DEGREE	354	354	302	307
ETH-64	PAR64 (ALTMAN AND L&E)	254	254	202	202
ETH-643	SHORT PAR64 (ALTMAN AND L&E)	254	254	76	202
ETH-16	PAR16	73	73	51	51
EAP-T6	S4 PAR ROUND FRAME, S4 ZOOM, S4 PARNEL	191	191	152	166
EAP-T3	SHORT S4 PAR ROUND FRAME, S4 ZOOM, S4 PARNEL	191	191	76	166

Half Top Hats

Size: mm

EAP-H6/H3

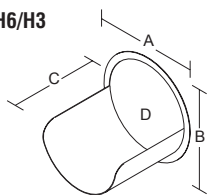

ETP-H6/H3

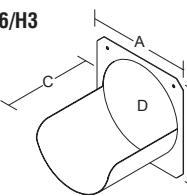

Half Top Hat is functioning like top hat, but just with half cylinder, therefore the light spill blocking is subject to the desired direction where the half top hat is placed.

Product Code	Distance	A	B	C	D
ETF-H5	S4, SL, SHAKESPEARE, SELECON Pacific/SPX	159	159	126	126
ETF-H3	SHORT S4, SL, SHAKESPEARE, SELECON Pacific/SPX	159	159	76	126
ETP-H6	S4 ZOOM, S4 PAR, PARNEL, 6" LEKO, 360Q	191	191	152	166
ETP-H3S	S4 ZOOM, S4 PAR, PARNEL, 3" LEKO, 360Q	191	191	76	166
ETF-H8	PAR64 (ALTMAN AND L&E)	254	254	202	202
ETF-H10	S4 10 DEGREE, SL 10 DEGREE	305	305	252	252
ETF-H12	S4 5 DEGREE	354	354	302	307
ETP-16	PAR16	73	73	51	51
EAP-H6	S4 PAR ROUND FRAME HALF TOP HAT 6"	191	191	152	166
EAP-H3	S4 PAR ROUND FRAME HALF TOP HAT 3"	226	226	76	166



LIGHTING CONTROL ACCESSORIES

Pattern Holder

Size: mm

ETF-GM

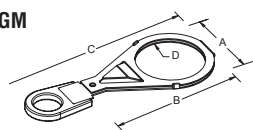

ETF-PM

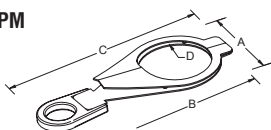

ETF-PA/PB/PD

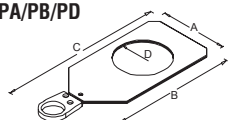

Pattern holder is a metal frame made to accommodate a metal gobo, leaving the metal free from warped. Heat-resistance plastic knob is mounted atop for convenient utility. It is placed directly in the focal plane of the fixture so as to project the image. Glass holder is also available for a glass gobo to fit it.

Product Code	Distance	A	B	C	D
ETF-PA	A SIZE PATTERN HOLDER FOR S4	94	174	228	81
ETF-PB	B SIZE PATTERN HOLDER FOR S4	94	174	228	70
ETF-PD	B SIZE PATTERN HOLDER FOR SELECON PACIFIC/SPX	114	201	250	70
ETF-GHS	86mm OD GLASS (GOBO SLOT) PATTERN HOLDER FOR S4	94	184	238	70
ETF-GH	82mm OD GLASS (GOBO SLOT) PATTERN HOLDER FOR S4	94	184	238	70
ETF-GHD	86mm OD GLASS (GOBO SLOT) PATTERN HOLDER FOR SELECON PACIFIC/SPX	114	201	250	70
ETF-PM	M SIZEZ PATTERN HOLDER FOR S4 JUNIOR	69	109	157	54
ETF-GM	M SIZE GLASS HOLDER FOR S4 JUNIOR	69	109	162	54
ETF-PC	PATTERN HOLDER FOR COLOR STRAN 5/50 SERIES	102	175	175	78

Color Extender

Size: mm

ETF-CE5/CE3

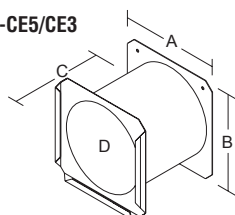

Color Extender is the combination of gel frame and top hat; two functions in one device. Gel slot is at the front of the unit, leaving more space for heat to travel and cool down, which eliminates gel burnout.

Product Code	Distance	A	B	C	D
ETF-CE5	S4, SL, SHAKESPEARE, SELECON Pacific/SPX	159	159	126	126
ETF-CE3	SHORT S4, SL, SHAKESPEARE, SELECON Pacific/SPX	159	159	76	126
ETF-64CE	PAR64 (ALTMAN AND L&E)	254	254	126	202
ETP-CE6	S4 ZOOM, S4 PAR, PARNEL, 6" LEKO, 360Q	191	191	152	166
ETP-CE3	S4 ZOOM, S4 PAR, PARNEL, 3" LEKO, 360Q	191	191	76	166

Donut

Size: mm

ETF-DT

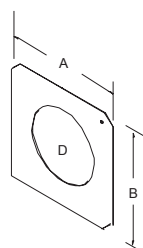

Donut is functioning as top hat, not only eliminating the spill of light but also reducing the lens flare and unwanted scattering light for sharpening the projected patterns and images.

Product Code	Distance	A	B	C
ETF-DT	S4, SL, SHAKESPEARE, SELECON PACIFIC/SPX	159	159	76
ETF-DT3	6" LEKO, 360Q	191	191	76
ETF-DT6	S4 10 DEGREE, SL 10 DEGREE	305	305	150
ETF-DT7	S4 5 DEGREE	354	354	182



Egg Crate Louver

Size: mm

EAP-L

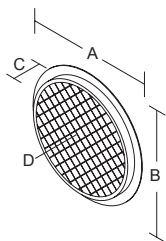

Egg Crate Louver is an architectural accessory and cuts off 45 degree angle of the light. It eliminates the distracting glare, renders more precise light distribution, shields lamps from direct view, and reduces luminaries surface brightness for maximum visual comfort.

Product Code	Distance	A	B	C	D
EAP-L	S4 PAR EGG CRATE LOUVER	191	191	13	166

Note: Give A 45 Degree Cutoff Angle; Keep The Audience From The Glaring Light Of The Lens.

Beam Bender

Size: mm

ETF-BB

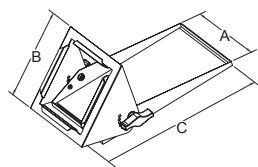

Beam Bender is made with an adjustable mirror so as to change the angel of beam output. It is an ideal and helpful device for projecting the light around irremovable obstructions. The fixture could be concealed, and with beam bender, the light output could reach the area with maximum output.

Product Code	Distance	A	B	C	D
ETF-BB	S4	175	155	310	-

Note: Adjust Beam Angle, Reach Maximum Light Output At Floor Level.

Concentric Ring

Size: mm

ETP-CR

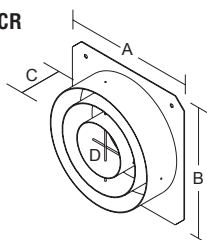

It is built up with three concentric cylinders to get the comparable function to a full 6" top hat but just with only in 2" profile. Concentric ring offers full control of spill and scattering beam for the S4 PAR and ParNel.

Product Code	Distance	A	B	C	D
ETP-CR	S4 PAR CONCENTRIC RING 2"	191	191	52	166

Note. Compatible To 6" Top Hat; Control Of Stray Beams And Spill

Concentric Ring

Size: mm

ETF-CF

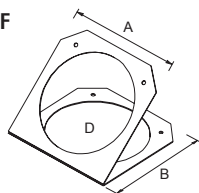

EAP-CF

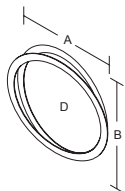

Product Code	Distance	A	B	C	D
ETF-CF137	S4, SL, SHAKESPEARE, SELECON PACIFIC/SPX	159	159	-	137
ETF-CF152	6" LEKO, 360Q	191	191	-	152
ETP-CF172	S4 ZOOM, S4 PAR, PARNEL	191	191	-	172
ETF-CF203	PAR64	254	254	-	203
ETF-CF254	S4 10 DEGREE, SL 10 DEGREE	305	305	-	254
ETF-CF304	S4 5 DEGREE	354	354	-	304
EAP-CF	S4 ROUND FRAME	190	190	-	165

Adaptor

Size: mm

ETF-ADP

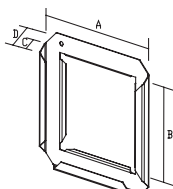

Product Code	Distance	A	B	C	D
ETF-ADP	159mm to 191mm adaptor for S4, SL, SHAKESPEARE, SELECON	192.5	136	12.5	22.5



Barndoor

Barndoor is generally constructed of four leaves and attached to the front of lighting fixture to shape the beam of the light. It is usually used for the diffuse light like a Fresnel, flood light, and Par Can, in order to get a more focused coverage field or prevent the light spilling into the areas where it is not wanted. As “profile” light like Source Four has more focused beam, it is rarely used with barndoor.

ETP-BDR2

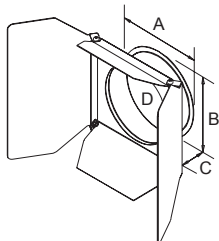

ETP-BDR
BDR-64B

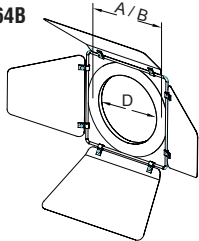

Product Code	Distance	A	B	C	D
ETP-BDR	S4 PAR, PARNEL	191	191	-	162
ETP-BDR2	S4 PAR, PARNEL WITH COLOR EXTENDER	191	191	50	173
BDR-64B	PAR64	264	264	-	218

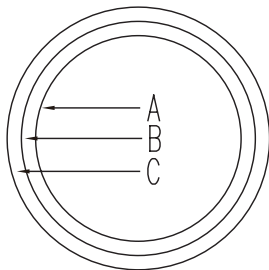
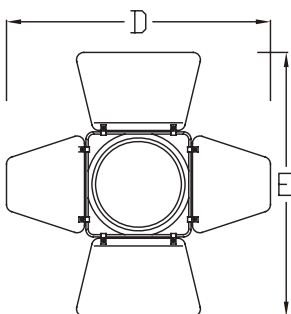

Product Code	A	B	C	D	E	Size: mm
BDR-LST150	63	78	90	174	184	
BDR-LST300	112	128	145	328	330	
BDR-LST650	145	160	175	400	414	
BDR-LST1000	180	195	217	497	504	
BDR-LST2000	223	245	286	560	587	
BDR-LST5000	316	345	385	800	830	
BDR-LST10000	478	504	520	1115	1175	
BDR-LSP575	187	194	216	495	506	
BDR-LST120	312	342	390	805	830	

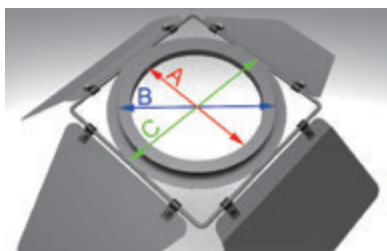

Four-leaves barndoors are also available in variety dimension for TV / Film lighting fixtures.

Beam Shape Change Lenses & Dichroic Color Filter

R5MFL/ NSP/ VNSP

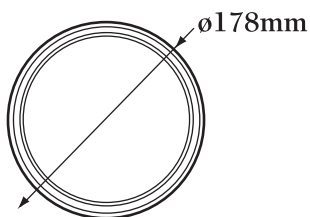

KP-DF172

KP-DF130
KP-DF

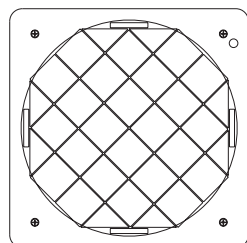
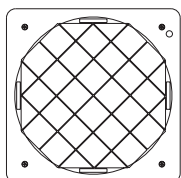

Product Code	Distance	Size: mm
R5MFL	Dia. 178 mm medium flood lens	
R5NSP	Dia. 178 mm narrow spot	
R5VNSP	Dia. 178 mm very narrow spot	
KP-DF130	Dia. 130 mm Dichroic filter for S4 w/safety color frame	
KP-DF172	Dia. 169.5 mm Dichroic filter for S4 par w/safety color frame	





Dichroic Filter



Dichroic filters are optically coated with dielectric thin films vacuum-deposited onto glass substrate. They transmit light of certain color and reflect the complementary color. Kupo assures the quality filters and the absolute spectral stability that expresses consistent shades and perfect images. No matter applied indoors or outdoors, Kupo dichroic filters are excellently resistant to environmental degradation. We have a comprehensive selection of colors that provides the flexibility for you to choose the suitable ones for your projects.



Specification

Color Tolerance

- Within ± 5 nm of designed central wavelength.

Technical Specification

- Humidity. Adhesion. Abrasion.
- Resistance MIL-M-13508C.

Features

- True-to-life colors.
- High transmission of desired light.
- Excellent heat resistance.
- Low maintenance & cost-saving.

Applications

- Architectural lighting.
- Entertainment and stage lighting.
- Precise use for electronics and industrial applications.

- Available Size
- Square: 7 - 300 mm
- Round: 10 - 425 mm

- Maximum Operation Temperature
- Soda-lime Material: 150 degree C
- Tempered Material: 250 degree C
- Borofloat Material: 450 degree C

Installation

To achieve a better effect, it is suggested to install the coated side of filter toward the light source. The filter should be set at the angle of 90 degrees to the light path to avoid undesirable color shift. Moreover, for the best color performance, the filters are not recommended to be placed at an extreme angle greater than 40 degrees in the lighting fixtures.

We offer diverse dichroic filters including

(1) Hot Mirror for Heat Reflection: high infrared energy reflection; block near UV energy for excellent visible transmission; ideal for museum and architecture professions.

(2) Cold Mirror for Heat Transmission: high infrared transmission; high visible light reflection; ideal for surveillance camera and medical illumination.

(3) UV Block Filter: high UV energy reflection and high visible light transmission; ideal for art gallery, museum or where the precious objects should be shielded from light damage.

(4) UV Transmission Filter: UV energy transmission and visible light reflection; perfect for fluorescent effect and tanning facility.



DFS-B Dichroic Sample Book

Characteristics

- 68 standard dichroic colors.
- 6 kinds of colors correction filters.
- 7 reflective color filters.
- 4 kinds of patterned glass.
- Color Comparison List with Kupo, Rosco and Lee colors.
- Substrate: Borofloat.



DICHROIC FILTER

(1) Long Pass

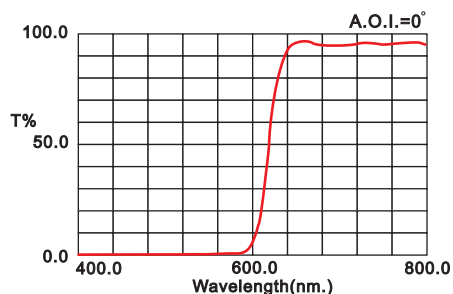

Y10001 Spring Yellow (Y0200) LEE#765	Y1002 Medium Yellow	Y10103 Yellow	O2210 Gold Orange	O1911 Sunset Orange	O16412 Orange (O1823) ROSCO#19 LEE#019
Y76704 Canary (Y89312) ROSCO#312 LEE#101	O10405 Amber	O01506 Straw	R2613 Fire (O0819) LEE#182	R2714 Red (R9926) ROSCO#26 LEE#026	R15 Ruby Red
O17907 Deep Amber	O15808 Light Orange	O77809 Golden Amber (O5921) ROSCO#21 LEE#021	R16 Blood Red	R17 Dark Red (R0027) ROSCO#27 LEE#027	R2918 Plaza Red

(2) Band Pass

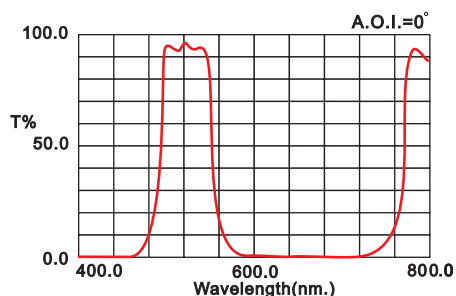

G32701 Forest Green	G32502 Mallard Green	G32503 Beryl Green	G73504 Velvet Green	G13905 Green (G28389)	G73606 Dark Green
G73607 Jelly Green	G73608 Grass Green	G13909 Primary Green	G2810 Light Green (G01)	G73611 Oasis Green	G2812 Fern Green
G73813 Pale Green	G73814 Lime Green	G74015 Yellow Green	G8916 Moss Green	G9017 Jade	G72918 Scuba Blue

(3) Notch

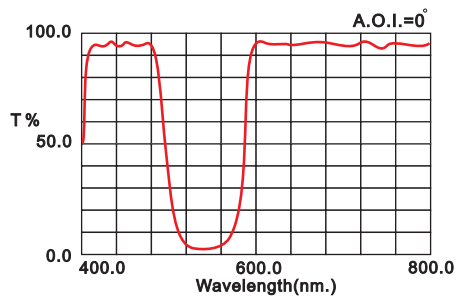

M5601 Magenta (M56339)	M79502 Magical Magenta	M79303 Vanity Fair	M4904 Plum	M12613 Fantasy Magenta	M79516 Dark Rose
M4905 Deep Magenta	M79506 Rose Pink	P12607 Mauve	M79508 Rose	M11114 Bright Pink	
P79909 Special Lavender	P12610 Light Purple	P79711 Purple	P79712 Deep Purple	M32815 Pink (M63336)	

(4) Short Pass

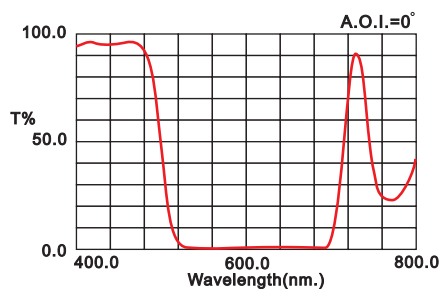

V7101 Blue-Purple (V6700)	V79902 Special Blue	B18103 Dark Blue (B01) ROSCO#59	B70704 Ultimate Violet	C35413 Steel Blue	C13116 Marine Blue
B71305 Blue (B4700) ROSCO#56 LEE#715	B19506 Zenith Blue	B8507 Bright Blue (B2879) ROSCO#79 LEE#079	B71408 Elysian Blue	C11514 Peacock Blue	
B6809 Sky Blue	B14110 Shiny Blue	B0611 Brilliant Blue (B06669) ROSCO#69 LEE#183	B11812 Light Blue	C11715 Italian Blue (C45370) ROSCO#370	

Note: Printed colors for reference only, not definitely identical to real dichroic colors.



Color Correction Series

KUPO Color Correction Filters are used in applications where it is desirable to change color temperature of various light sources. These subtle and less saturated tones are ideal for interior and exterior architectural lighting schemes.

Daylight Conversion

CTO-001

Full C.T.O. Converts
5500K Daylight to 2800K

CTO-002

Half C.T.O. Converts
5500K Daylight to 3800K

CTO-003

Quarter C.T.O. Converts
5500K Daylight to 4500K

Tungsten Conversion

CTB-001

Full C.T.B. Converts 3200K Sources
to normal daylight, 5500K

CTB-002

Half C.T.B. Boosts 3200K,
Sources to 4200K

CTB-003

Quarter C.T.B. Boosts 3200K,
Sources to 3600K



MR16 Glass Holder

Light-weighted and aluminum-machined rings with an enhanced spring provides a handy method for fixing a glass or dichroic with MR 16 bulb. It accepts a glass or dichroic in dia. 49.50mm and up to 1.3mm thickness to fix in. Finish with metallic silver.



Product Code	Distance
KP-DF50-RING	Dia. 49.5mm glass holder for MR16 (w/o glass)
KP-DF50	Dia. 49.5mm glass filter with holder for MR16



PAR-16/20 Glass Holder

Made of thermal plastic and features heat resistant. This holder offers a quick and simple way for a glass or dichroic to attach to a PAR-16/20 in the front gel clips. It accepts dia. 59mm glass for PAR-16, or dia. 68mm for PAR-20. Black finish.

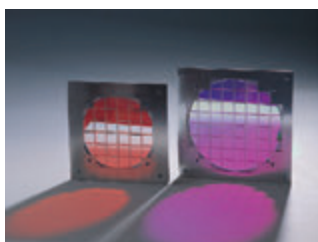

Product Code	Distance
KP-DF59-HOLDER-B	Dia. 59 mm glass holder for PAR16 (w/o glass)
KP-DF59	Dia. 59 mm glass filter with holder for PAR16
KP-DF68-HOLDER-B	Dia. 68 mm glass holder for PAR20 (w/o glass)
KP-DF68	Dia. 68 mm glass filter with holder for PAR20

KP-DF168

DIA. 168 mm dichroic filter for
PAR56 fixture with safety color
frame (with mesh).

KP-DF210

DIA. 210 mm dichroic filter for
PAR64 fixture with safety color
frame (with mesh).

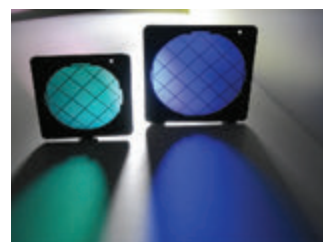
KP-DF130

DIA. 129.5 mm dichroic filter
for S4 with safety color
frame (with mesh).

KP-DF172

DIA. 210 mm dichroic filter for
PAR64 fixture with safety color
frame (with mesh).



Honeycomb

A honeycomb is an essential accessory for any lighting system used to minimize or eliminate glare from normal viewing angle. It is made up of the aluminum foil with a hexagon shape. It can be a shield to prevent the dazzle of illuminator. Honeycomb comes with different degrees to give creative effect. The honeycomb grid should be used in conjunction with a lens as it provides no protection for the lamp. Usually it decrease the center beam brightness by about 20%. Application is typical in up lighting, down lighting, illuminating art or any application where spill light would be objectionable.

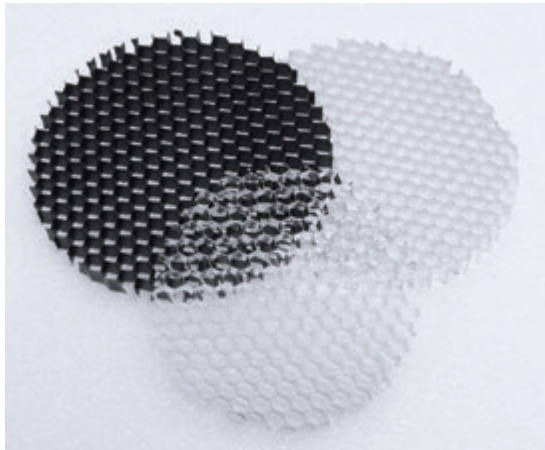

Feature

1. Change the shape and intensity of the light output from light source.
2. Lightweight.
3. Dazzle Prevention.

Quality Approval

1. RoHS certification.
2. The consistency of painting coating.
3. No painting fading under UV illumination.
4. With 250 degree C heat-resistance.

Specification

Material: Aluminum Foil.
Color: Black or Silver.

Available Size

Square: 35 mm - 300 mm
Round: 35 mm - 300 mm



Aperture sizes are available w/ the following dimensions

Cell Size			Cell Depth			Open Area
1/8" (3 mm)	3 mm	-	5 mm	6 mm	-	95 %
3/16" (4.5 mm)	5 mm	6 mm	9 mm	10 mm	-	95 %
1/4" (6 mm)	6 mm	-	10 mm	12.7 mm	20 mm	95 %
Cut Off	45 degree	52 degree	60 degree	65 degree	72 degree	-

Honeycomb Grid

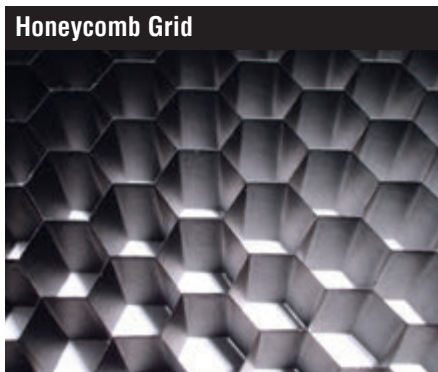

Lamp w/ Honeycomb Grid



Lamp Without Honeycomb Grid

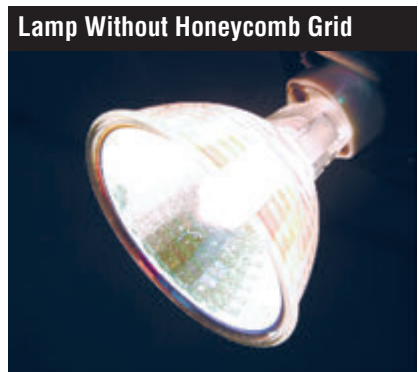

MR16 Honeycomb Holder

This elastic device is made of stainless steel with heat treatment, rendering honeycomb a flexible fit to any brands of MR16 bulb. With four bended teeth on the rim, it could hold the honeycomb firmly in the position to prevent falling off while attaching to the blub. It is also feasible to accommodate a glass or dichroic to fit in as well. Black coating finish.

Product Code	Distance
KP-HCH	MR16 Honeycomb holder





Coolite

Coolite series gooseneck lamps can be suited to lighting equipment, console, mixer and lighting cabinet rack or whatever a low light application needed. There are traditional halogen lamp (CH series) and innovation detachable LED (CL series) type. Both types are available in 12" and 18" length. Black finished as standard. XLR (3 Pin), XLR right angle (3 Pin) and BNC connectors are standard connectors, please specify when order.

HALOGEN LAMP



CH series have 8 mm diameter gooseneck and 12V / 5W high intensity lamp.

LED



CL series have 5 mm diameter gooseneck and 4 LED lamp (about 0.26W).

MOBILE HALOGEN LAMP



CH series have 8mm diameter gooseneck and 12V/5W high intensity replaceable lamp head.

BNC CONNECTOR



CH-12B
12" with BNC connector.
CH-18B
18" with BNC connector.

CL-12B
12" with BNC connector.
CL-18B
18" with BNC connector.

CH-12BM
12" with BNC connector.
CH-18BM
18" with BNC connector.

XLR 3 PIN CONNECTOR



CH-12X
12" with XLR 3 Pin connector.
CH-18X
18" with XLR 3 Pin connector.

CL-12X
12" with XLR 3 Pin connector.
CL-18X
18" with XLR 3 Pin connector.

CH-12XM
12" with XLR 3 Pin connector.
CH-18XM
18" with XLR 3 Pin connector.

XLR 3 PIN RIGHT ANGLE CONNECTOR



CH-12XR
12" with XLR 3 Pin right angle connector.
CH-18XR
18" with XLR 3 Pin right angle connector.

CL-12XR
12" with XLR 3 Pin right angle connector.
CL-18XR
18" with XLR 3 Pin right angle connector.

CH-12XRM
12" with XLR 3 Pin right angle connector.
CH-18XRM
18" with XLR 3 Pin right angle connector.

CL-712



Portable LED Table Lamp runs on 3 x AA1.5V batteries (included).



LGN-917

12" Gooseneck 3-pin XLR with on/off switch (LED head light).



On / off switch on XLR



CH-212
Rack Lighting with Double Gooseneck lamp Dimmer on-off switch 19" wide x 1.75".

OPTIONAL ACCESSORIES



LGN-9001
XLR female connector type
Dimmer
on-off Switch



LGN-9003
BNC female connector type
Dimmer
on-off Switch



LGN-0202
12V5W halogen bulb high intensity.



LGN-2203
Power adaptor
120V to 12V



LGN-2200
Power adaptor
230V to 12V



LGN-0200
5W halogen bulb.



Lighting Control System

DX-1220 and DX-1230 are digital DMX-512 modular dimmer pack, built up for 12-channel x 20A per pack or 30A per pack. They are ideal and reliable for theatre, concert hall, hotel, conference center, museum and art gallery, cinema, department store, entertainment center, disco night club, as well as architectural lighting design. A variety of functional and testing keys to help get maximum usage. Modular design enables you to change the modular pack without removing the whole unit.



DX-1220

12 Channel DMX Dimmer Pack;
Maximum Output 20A Per Channel.



DX-1230

12 Channel DMX Dimmer Pack;
Maximum Output 30A Per Channel.

Features

- 12 individual extractable modules with 12-channel control.
- DMX-512 and analog input.
- A MCB (NFB) for each channel.
- Output for each channel can be limited to protect the lamp.
- Emergent scene setting function to output scene data when losing DMX control signal.
- Thermo-controlled fan will be activated when the temperature is over 37°C; cease the output when over 63° C and restart below 60°C.
- Self-testing function to test without a console.
- Options of dimming or switch for each channel.

Specification

- Power: AC 100-240V; 45-63Hz, 3 phase 4 wire (other spec upon request)
- Protocol: DMX-512
- DMX signal connection: XLR 5-pin
- Analog signal input: DC / 0-10V
- Analog signal channel: 12 channel (pin1-pin12:CH1-CH12, pin15:GND)
- Analog signal connection: D type plug 15-pin
- Installation: 19" 4U standard rack
- Dimension: 482 (W) x 176 (H) x 297(D) mm
- Weight: 21kgs (DX-1220); 21.5 kgs (DMX-1230)



DX-404 Dmx Dimmer Pack

- Maximum 5A per channel, total 15A
- DMX512 signal
- Most advanced 'C3' dimming curve
- 256 steps resolution
- DMX start addressing setting
- Channel output status preview
- Auto frequency tracking
- Warm-Up setting 0-6%
- Automatic warm up function, protects loads and extend the life of bulbs.



STRUCTURE

- Power AC 100-120V, AC 200-240V, 45-63Hz.
- Signal connector XLR 3 Pin, 6P4C (RJ11) telephone jack.
- Location TRUSS hanging or desktop operation.
- Dimension: 240(W) x 88(H) x 120(D) mm.
- Weight: 1.2 kg.

DP-3A INTERFACE



Decode DMX signal into analog signal, start channel selectable.

DATA

- Power input AC 100-240V, 45-63Hz.
- Output channel 72 channels.
- DMX signal input / output DMX512 / 1990.
- DMX signal connection XLR 5 Pin.
- Analog signal output DC 0-10V.
- Analog signal output.
- channel 01 to 24: Pin 1-24: CH01-24; Pin 25: GND
- channel 25 to 48: Pin 1-24: CH25-48; Pin 25: GND
- channel 49 to 72: Pin 1-24: CH49-72; Pin 25: GND
- Analog signal connection D-Type plug 25 Pin.
- Dimension: 482(W) x 44(H) x 240(D) mm.
- Rack size 19" 1U rack mountable.
- Weight: 2 kg.

DP-81 DMX SPLITTER PANEL



DATA

- Power AC 100-240V.
- Control signal input 1PCS 5 Pin XLR female.
- DMX signal output / input DMX512 / 1990.
- Control signal output 8PCS 5 Pin XLR male.
- Dimension: 482(W) x 44(H) x 113(D) mm.
- Rack size 19" 2U rack mountable.
- Weight: 1.16 kg.

CX-1C TESTER



- Light & handy, portable.
- Available for testing synchronized signal DMX-in/ DMX-out.
- Build-in battery, it can work for several hours continuously (charge it 5hrs., it can work 3hrs. or waiting 100hrs.) LCD background lighting economizes on power to extend battery life.

Sleeping device

Stop working in 5min. running, it will be in the mode of sleeping to extend battery life.

DATA

- Power DC 12V / 1A.
- Battery type AAA 1.2V 4PCS rechargeable.
- DMX signal output channel DMX512/ 1990.
- DMX signal connection XLR 5 Pin (x2)- phone jack RJ11 (x2).
- Dimension: 100(W) x 133(H) x 50(D) mm.
- Weight: 0.75 kg.



Digi-check Multi-function DMX Tester



DIGI-CHECK is designed for DMX diagnosis and cable tester.

The smallest and compact device that combines detect unit and white LED torch light.

Feature

- 9 LEDs indicate the status of DMX signal & data line in detail, Switch off automatically when suspending for 120 seconds; save battery life.
- Easy to change battery without any tool.
- Come with leather pouch and strape for max portability.
- Aluminum housing, CNC treated, anodized, Bright LED torch light/ White, 3 PIN/ 5 PIN male & female XLR plug,
- Low power consuming.

Product Code	Description	Dimension	Weight (kg)	Battery
DC-920	5 pin Digi-check	22 x 137 mm	0.15 kg	LR44 x 3PCS (included)
DC-930	3 pin Digi-check			
Function				
Embedded one white LED as a torch light, DMX-512 signal level and load analyser, Individual data line inspector, Installed data line inspector. Power DC 12V/1A. Battery type AAA 1.2V 4pcs rechargeable batteries. DMX signal output channel DMX512 / 1990. DMX signal connection XLR 5 pin (x2) - phone jack RJ11(x2).				

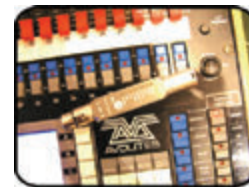

New Innovated Function

For those cables installed and not to have checkup, use one Digi-check at each end to implement inspection.
(in such function, one XLR female adaptor will be required to use in the same time)



DIGI-SIT

Mounted resistor providing termination to DMX cable. Signal rescuer if inadequate DMX cable is used. Embedded red LED gives constantly voltage check. Die-casting cap with keyring hole leaves durability and portability to stagehand.

Product Code	Description	Dimension	Weight (kg)
DS-TM3	XLR 3 PIN	100(W) x 133(H) x 50(D) mm	0.40 kg
DS-TM4	XLR 4 PIN		
DS-TM5	XLR 5 PIN		





DF-500

Is a powerful and versatile special wind machine designed for studios, theaters, theme parks, touring, photographic and more. It is suitable for wide range application including blowing haze, smoke, bubbles, confetti or snow, cooling performers, dimmer racks or amplifiers even drying paint in studio. DF-500 can be controlled through standard DMX signal or master/slave operation through data link. Versatile yoke for overhead rigging, floor sitting or stand mounting. Housing is constructed from a molded lightweight plastic venting device with rugged tubular steel surrounded for transport and protection. The 11" one-piece blade and spiral front grill for creating narrow focus wind stream. Compact, lightweight and powerful.



YOUTUBE
DMX WIND MACHINE

Specification

- Power input: 100-240V AC, 1200W, Current Max. 10A.
- Motor: 500W, Max. 3500RPM.
- DMX mode: DMX on-off and volume control.
- Memory: 9 mode memory setting available.
- One touch turbo function: 0-3500RPM within 5 sec.
- Air volume: 1700CBM / hr .
- Wind speed: 60KM / hr .
- Remote controller: Supplied w/3M cable.
- Built-in master / slave control interface.
- Dimension: 480 x 560 x 460 mm.
- Weight: 12.5 kg.

FOUR REASONS DIGIFAN MAKES A VORTEX WIND EFFECT

ALWAYS PUT THE FAN BEHIND THE SMOKE SOURCE SO AS TO NOT GUM UP THE FAN WITH FLUID.



11" one piece deep pitch blade churn through the air, maximizing the amount of the air moved with the each turn of powerful motor.



The spiral shape designed front grill offset the direction of the air as it twists off the blade. This allows the air to travel long distance.



Air inlet duct tube ensures that the deep blade are fully enclosed in a cylindrical duct, air is sculpted into a column (beam of air).

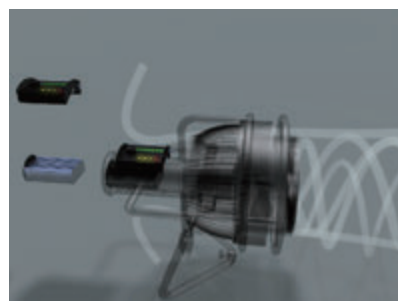

To combine deep pitch blade, spiral grill, ducted tube and a switching power supply the multi function Digi fan is able to create a fully controllable vortex wind effect.

DigiFan Features



Multi functional control box for Manual, DMX and Program setting.



Switch for local or DMX operation mode.



Switching power supply with aluminum enclosure.



On/Off switch, universal 100-240V power input and fuse protection.



Molded plastic venting encompassed by rugged steel frame.



Sitting on floor by its own floor stand.



Sitting on stand with 28mm spigot.



Rigging on truss through the 13mm hole in the center of the bracket plate.



Industrial grade 500W, Max. 3500RPM Motor.



Locking knob with bearing for tighten yoke and adjusting direction.



11" one piece deep pitch blade.



LINK

Master and Slave - Up to 9 Fans can be locally controlled by one controller using DMX data link.



Dimension

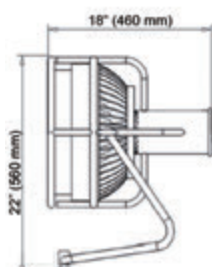
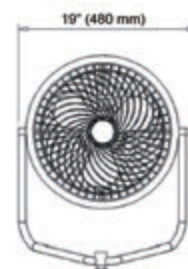



MB-055 DMX Mirror Ball Motor



Apart from conventional one, DMX mirror ball motor offers a flexible and selective control for the rotation, and generates much more diverse effects. It is compatible with standard DMX-512, and runs for 2 channels. The metal chassis is compact and sturdy, and also comes with a M10 fixing hole on top of bracket which makes installation easy and fast. It is designed to fit wide range of mirror ball size up to diameter 50 cm.

Features

1. Runs for 3 functions: DMX, stand-alone, master-slave.
2. Two DMX channels: channel one is output control where you could plug in lamp up to 60 W; channel two is motor control for controlling motor travel from 0.5RMP to 5R MP, for clockwise or counterclockwise rotation.
3. DMX-512 control: fully compatible with standard DMX protocol. The LED indicator will flash with 2 Hz while receiving the correct data.
4. Master-Slave: Any unit of the link can act as a master, and make the others in this link run synchronously. No controller or DMX signal is required in this mode.
5. Stand Alone: Speed and direction can be controlled by DIP switching.



Specification

- Power Input: AC90-250V 60 Hz.
- Power Consumption: 10W (Max).
- Fuse: 3 A.
- DMX Channel: 2 channels (one for motor / one for power output).
- Power output: 60 W (Max) .
- Max Load: Dia. 50 cm (20") mirror ball.

Mirror Ball

E0502 2" mirror ball
E0504 4" mirror ball
E0508 8" mirror ball
E0510 10" mirror ball
E0512 12" mirror ball

E0516 16" mirror ball
E0520 20" mirror ball
E0524 24" mirror ball
E0540 40" mirror ball
E0550 50" mirror ball

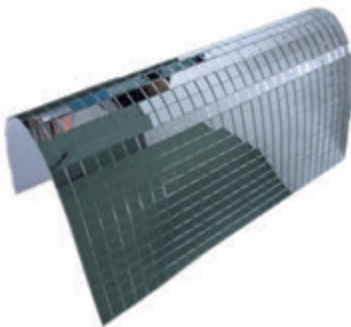

MM-1212 Mirror Mat for 12" *12" glass

- 12 inch x12 inch flexible mirrored tiles sheet.
- Attach to walls, cylinders and more.
- Glass tiles 1.1 cm x 1.1 cm.
- Double sided tape .

Mirror Ball Motor



MBM-01
For 8"-20"
mirror ball



MBM-02
For 24"-30"
mirror ball



MBM-03
or 40"-60"
mirror ball



Goreal Intercom

Goreal intercom system, including headset, belt pack and power station, is designed to fulfill the requirement for entertainment. It is a system featuring portable, compact, plug-n-play with no complicated settings. This system is ideal for the live event while the local communication is required, and making the communication clear, authentic and real-time.

Headset

The sophisticated headset with 270 degree rotatable mic provides greatest convenience for operation. Simply swing mic boom upward or downward to turn on or switch off the talking mode. Soft synthetic leather, complete embraced ear muffs, and adjustable headband makes the listening comfortable. Noise-proof and reliable.



GR-801 [Single Muff]



GR-802 [Double Muff]



SPECIFICATION

Headphones Type	Circumaural, closed-back
Sensitivity	90dB SPL
Frequency Response	20-20,000 Hz
Max. Input Power	100mW
Rated Impedance	400Ω
Microphone Element	Dynamic
Frequency Response	150-10,000 Hz
Polar Pattern	Cardioid
Rated Impedance	250Ω
Open Circuit Sensitivity	-60 dBV/Pa (1.0mV/PA) ±3dB, at 1KHz
MAX. SPL:	136dB SPL (THD≤1%, at 1KHz)
Distortion	<3%
Connector/Cable	4Pin/1.6M

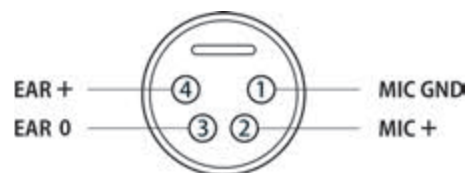

4PIN XLR MALE

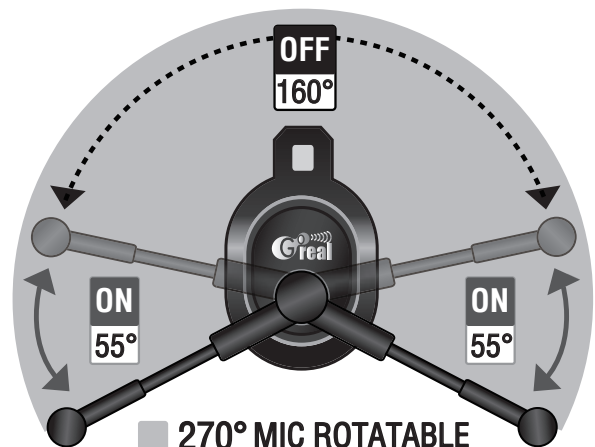

270° MIC ROTATABLE



Belt Pack

Belt pack is made of sturdy aluminum alloy housing making it much durable in touring. The rear metal clip makes this unit to hang on the wall or attach to the belt easily. The illuminating CALL button makes it pretty visible in the dark backstage. MIC button is made with bright yellow for easy identification. It comes with 3pin and 4pin socket connectors for interconnection.



GR-BP01 [Belt Pack]



1. "MIC" button
2. Voice (sidetone) level knob
3. Listen level knob
4. "CALL" indicator
5. Outlet for headset
6. Inlet for circuit cabling
7. Outlet for next belt pack

SPECIFICATION

Power Requirement	24-30VDC
Earphone Output	200Ω
Microphone Input	200Ω dynamic
Measurement	106 x 113.5 x 52.7 mm
Weight	0.42 kgs

Power Station

The housing of power station is made of robust aluminum alloy extrusion. No worry for the AC power as it takes universal input (90-240V). Two circuits for respective maneuver, or looping them all in one group for real-time communication for maximum 20 units of belt pack (GR-PS01). It comes with 3pin socket connectors for interconnection.



GR-PS01 [Power Station]

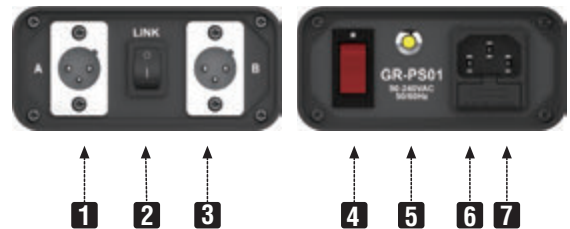

1. Outlet for circuit A
2. On/Off switch for circuit A+B
3. Outlet for circuit B
4. On/Off switch for main input
5. Main power indicator
6. Main power inlet
7. Fuse socket

SPECIFICATION

Input Voltage	90-240VAC, 50/60Hz (0.8A/115VAC, 0.56A/230VAC)
Output Voltage	Max. DC/27V, 1.7A
Measurement	106 x 269 x 45 mm
Weight	0.86 kgs

GR-PS02

Same as GR-PS01 for working with universal power input (90-240V), this power station powers up to 60 units of belt pack in same time for operation. Three channels A/B/C can be linked up as A+B, or B+C, or put them all together A+B+C for larger group. It is made to fit standard 19" rack. Low profile and compact.



1. Channel A outlet for belt packs
2. Channel B outlet for belt packs
3. Channel C outlet for belt packs
4. Link up Channel A and B
5. Link up Channel B and C When these two buttons are pressed, Channel A, B, C are all linked up all together
6. LED indication for power status
7. AC power switch

SPECIFICATION

Input Voltage	90-240VAC, 50/60Hz
Output Voltage	Max. DC / 24-27V, 3.8A
Measurement	4.5 x 48 x 23 mm
Weight	3.5 kgs



PG-400

The PG-400 Pro-Silk is a professional mist producer. It provides a light constant mist to enhance light beams. The silk comes with a high quality air compressor instead of the heater and temperature control; so, there is no more problem that you have met in the traditional fog machine.



Features

- Fine & long-hanging haze.
- More powerful compressor for a bigger volume.
- Leave no oil residue.
- Special designed tank to protect from liquid spill out.
- Low oil consumption (1 Liter for 48 HRS).
- No need warm up, instant operation.
- Built-In fan.

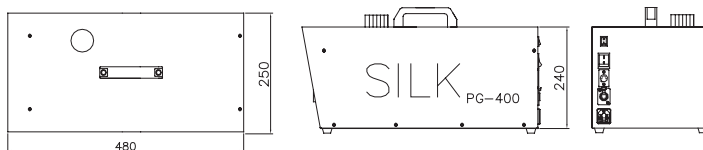

PG-500

The PG-500 Pro-Silk is a professional mist producer. It provides a light constant mist to enhance light beams. No more problems that you have met in the traditional fog machines. PG-500 Pro-Silk comes with flight case for keeping noise-free performance and safety transportation. Designed for theatre, T.V. studios and live show....



Features

- Fine & long-hanging haze.
- Leave no oil residue.
- Built-In fan.
- No need warm up, instant operation.
- Powerful compressor for a bigger volume.
- Portable and compact size.
- With flight case for keeping noise-free performance.
- 1 Liter liquid for 28 Hrs.

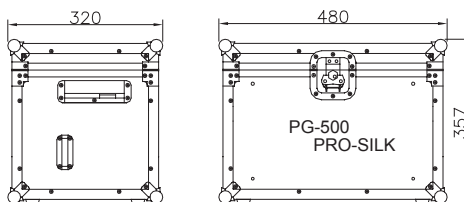

LIQUID

HZL-1 OIL BASE

It is a non-toxic solution that produces a pure translucent haze with a long hang time and low moisture content.

HZL-1W WATER BASE

Both are 1 Liter for haze machine and comply with the strictest health and safety regulations.